

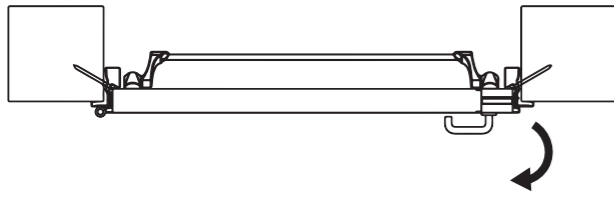

<https://www.dimak.com.tr/>
+90 312 554 5050
@dimakkapi

Door Types



Corner Frame
Left Door

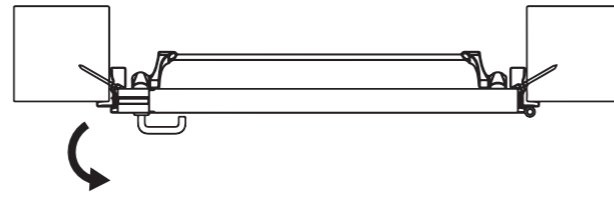

Corner Frame
Right Door

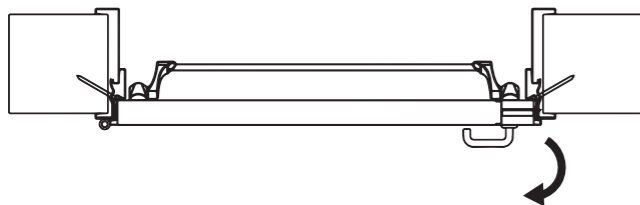

Full Frame
Left Door

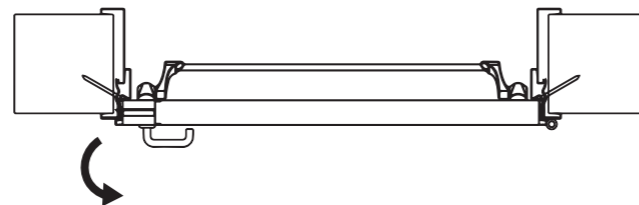

Full Frame
Right Door

Properties



E120
EI₂60, EI₂45, EI₂20



E90, E60
E₂90, E₂60, EW90

- Tested according to EN1634-1 standards.
- The frame and the leaf is made out of galvanized steel.
- The door is coated with electrostatic powder paint.
- Spring hinge is used.
- The handle and panic device are cast aluminum.

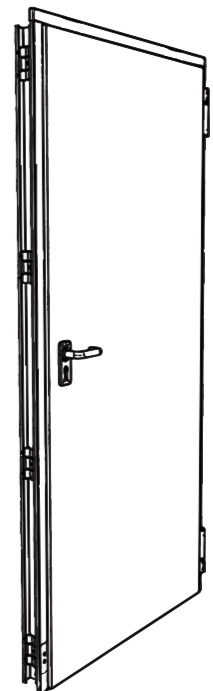
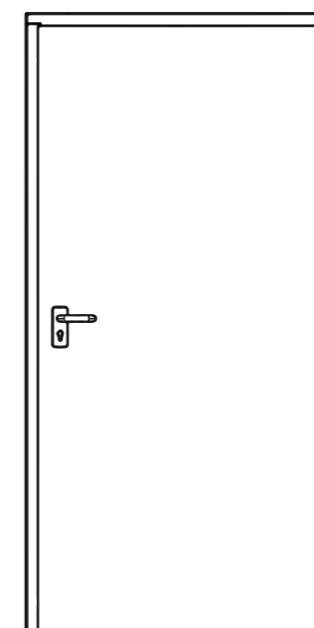
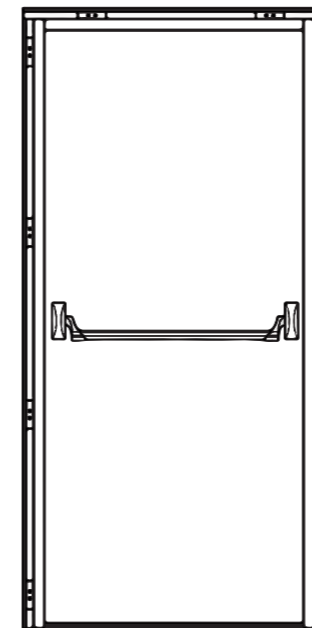

Parts

● Frame and Leaf Parts

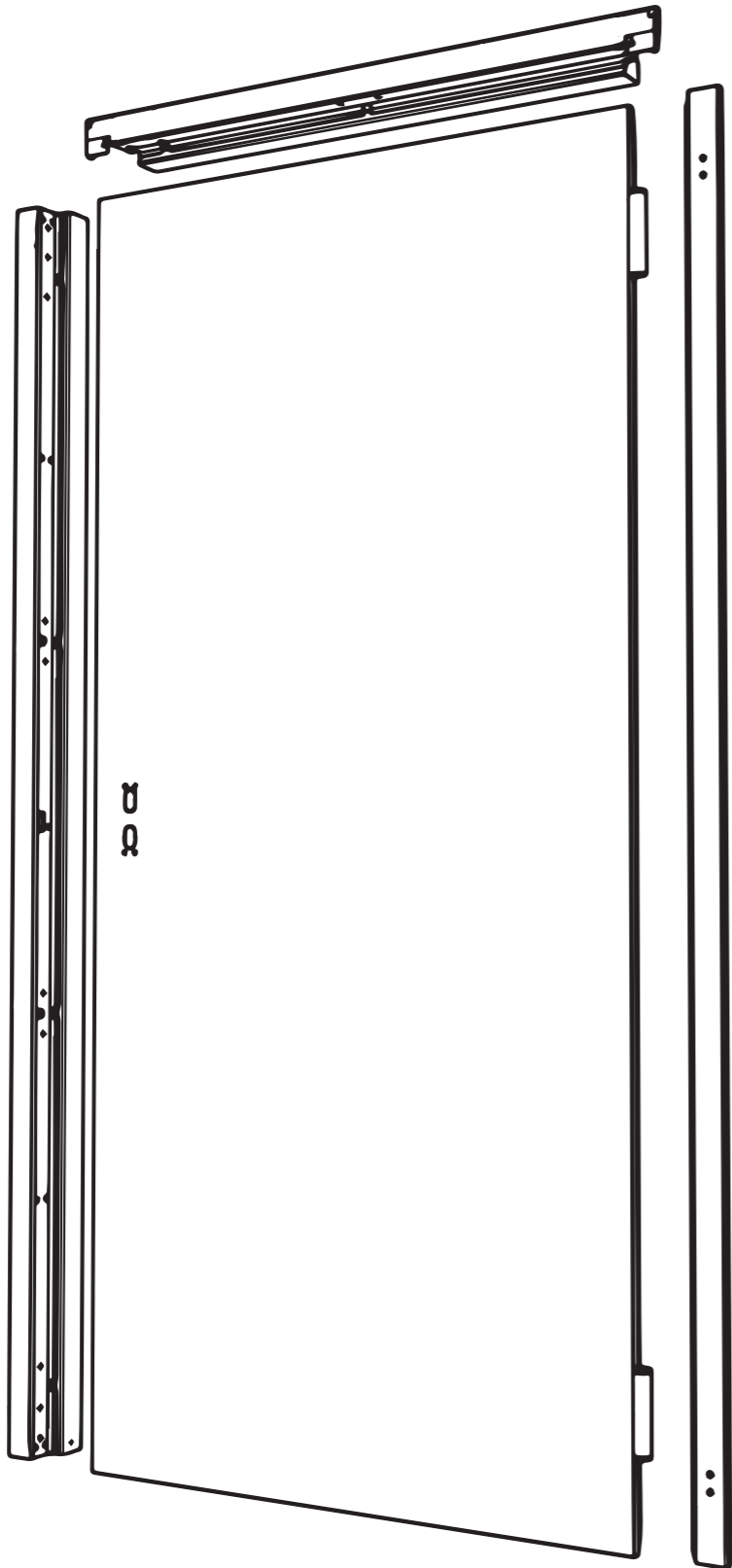

● Frame and Leaf Montage Parts

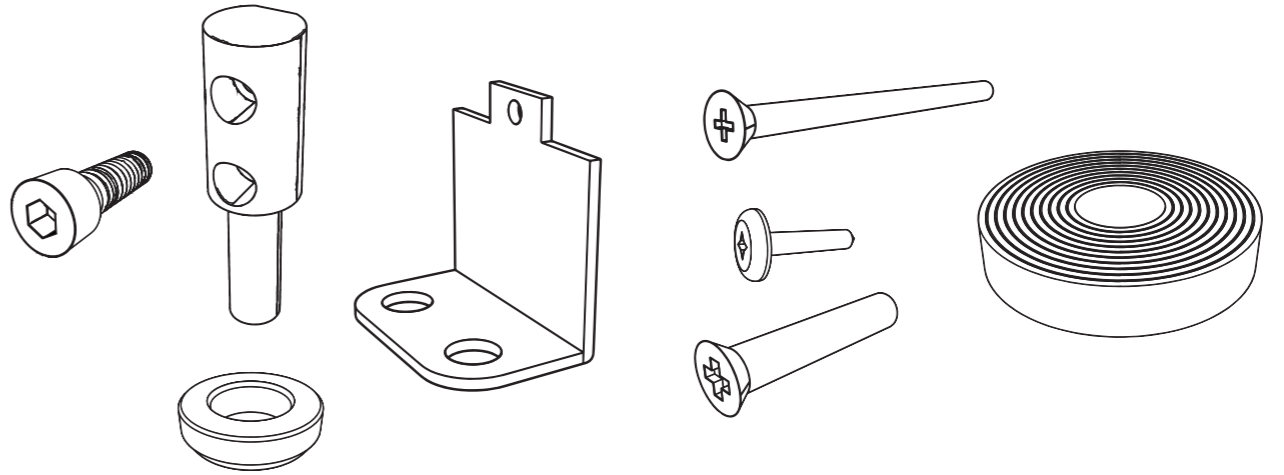

● Dimak Accessory Box (Panic Bar + Handle)

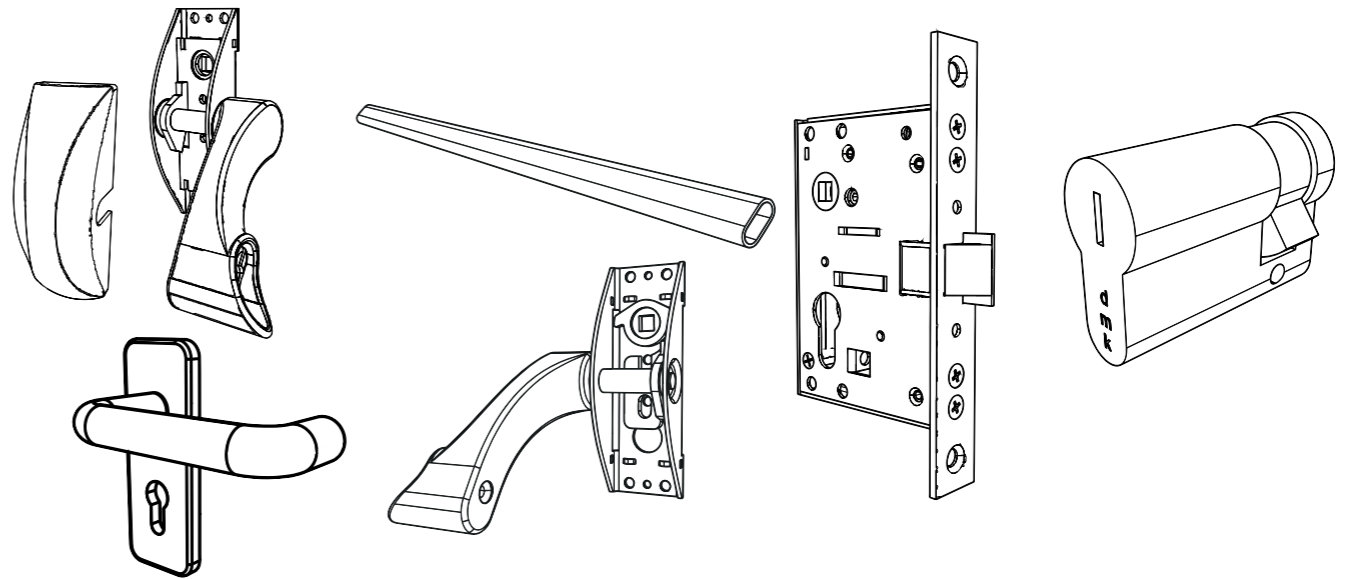

● Dimak Accessory Box (Handle + Handle)

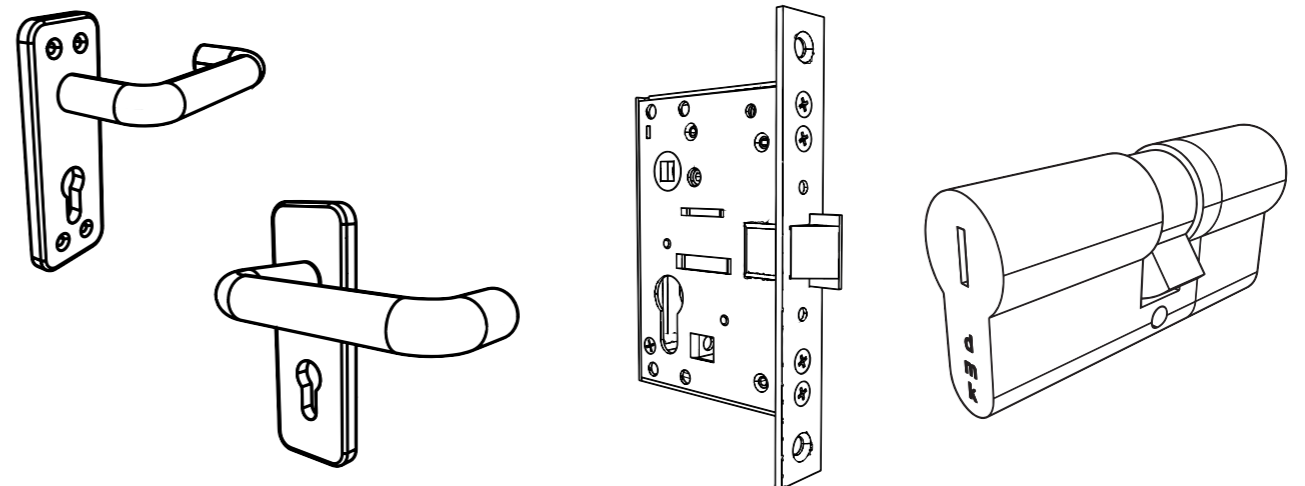

Left - Right Assignment on Reversible Door Frames

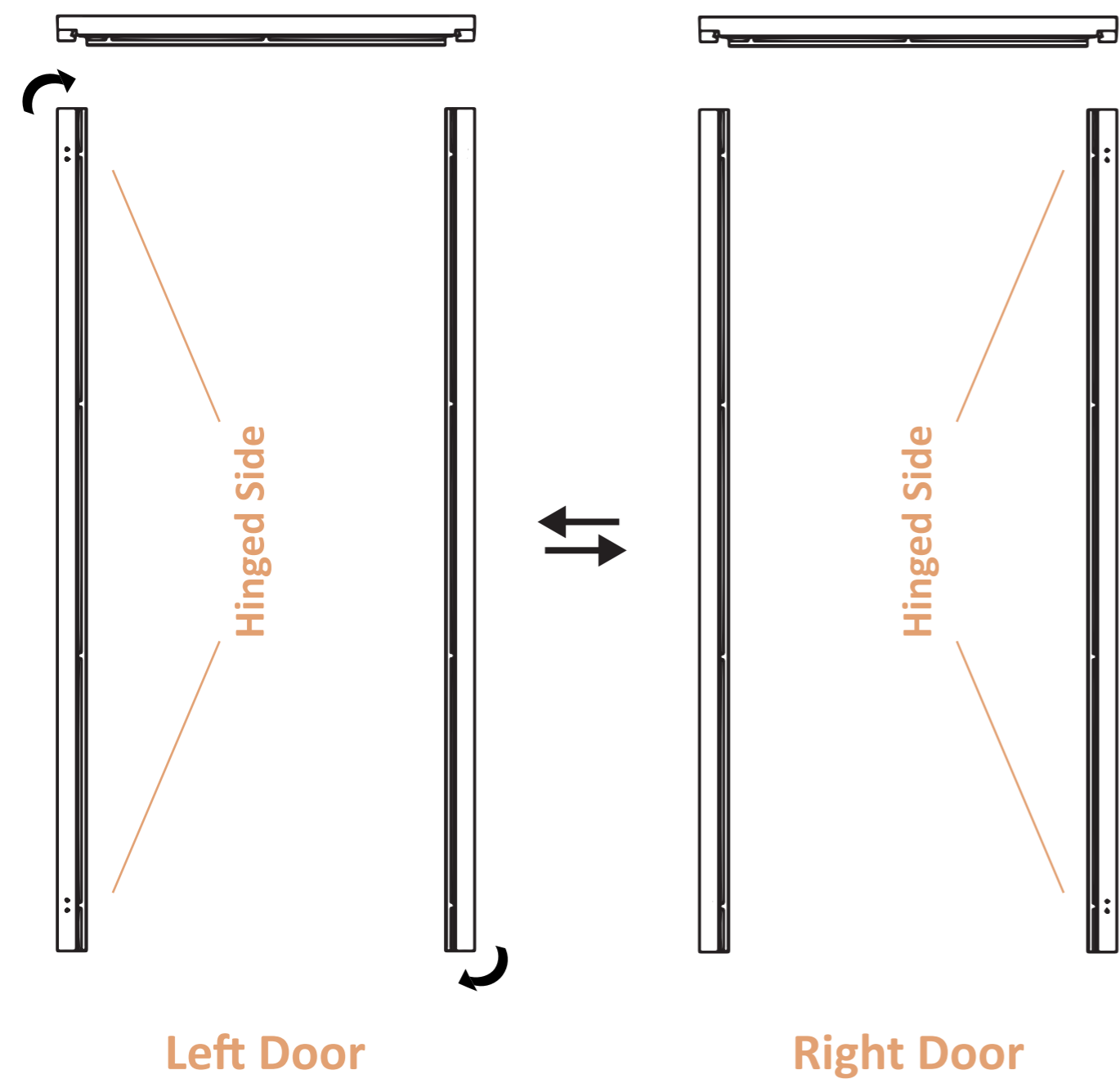

After deciding the opening direction of the reversible door the top part of the frame is mounted to the side frames.

Left - Right Assignment on Reversible Door Leaf

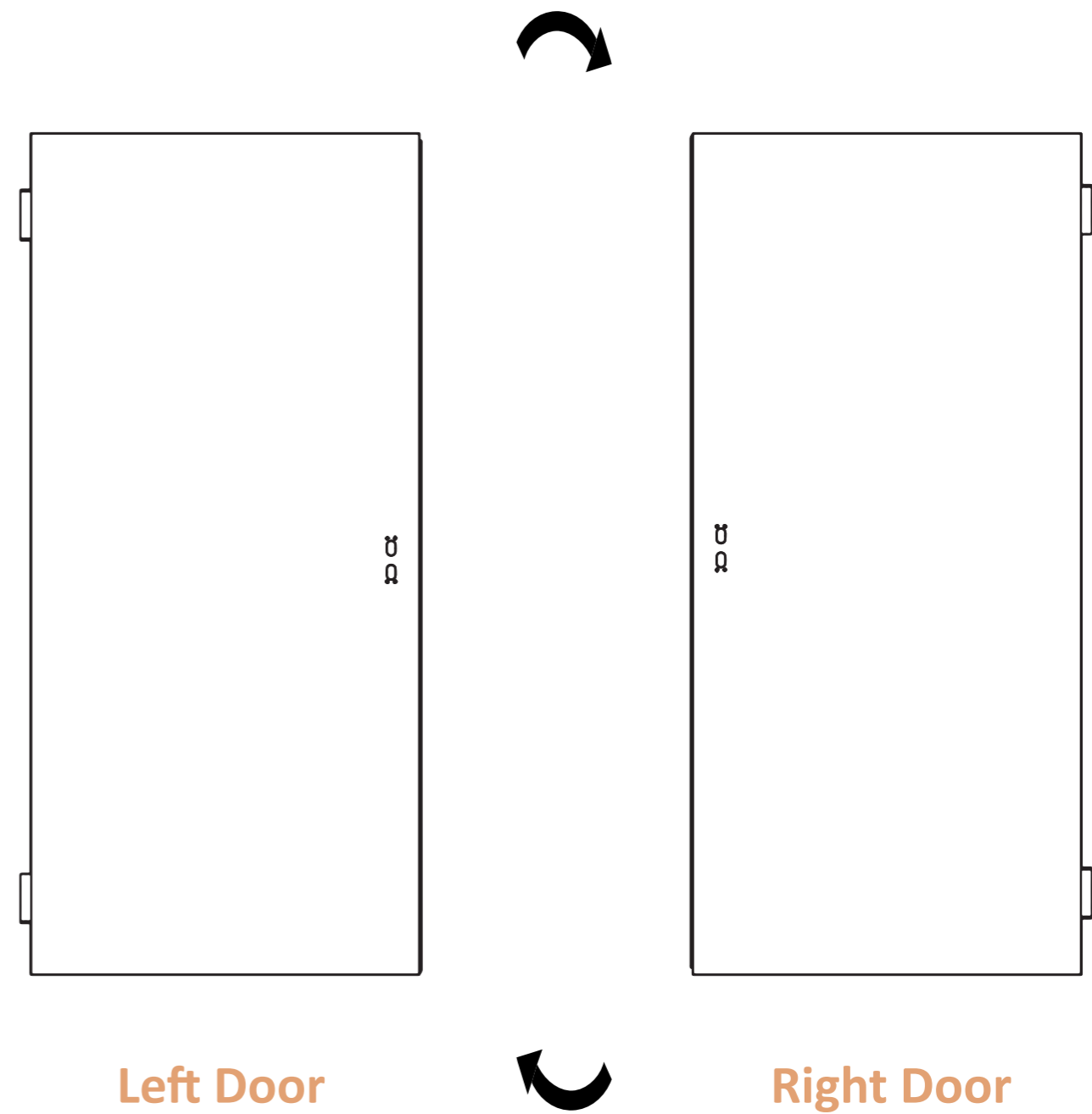

Turn the leaf according to the hinged side of the frame.

Assigning the Direction of the Doorhandle

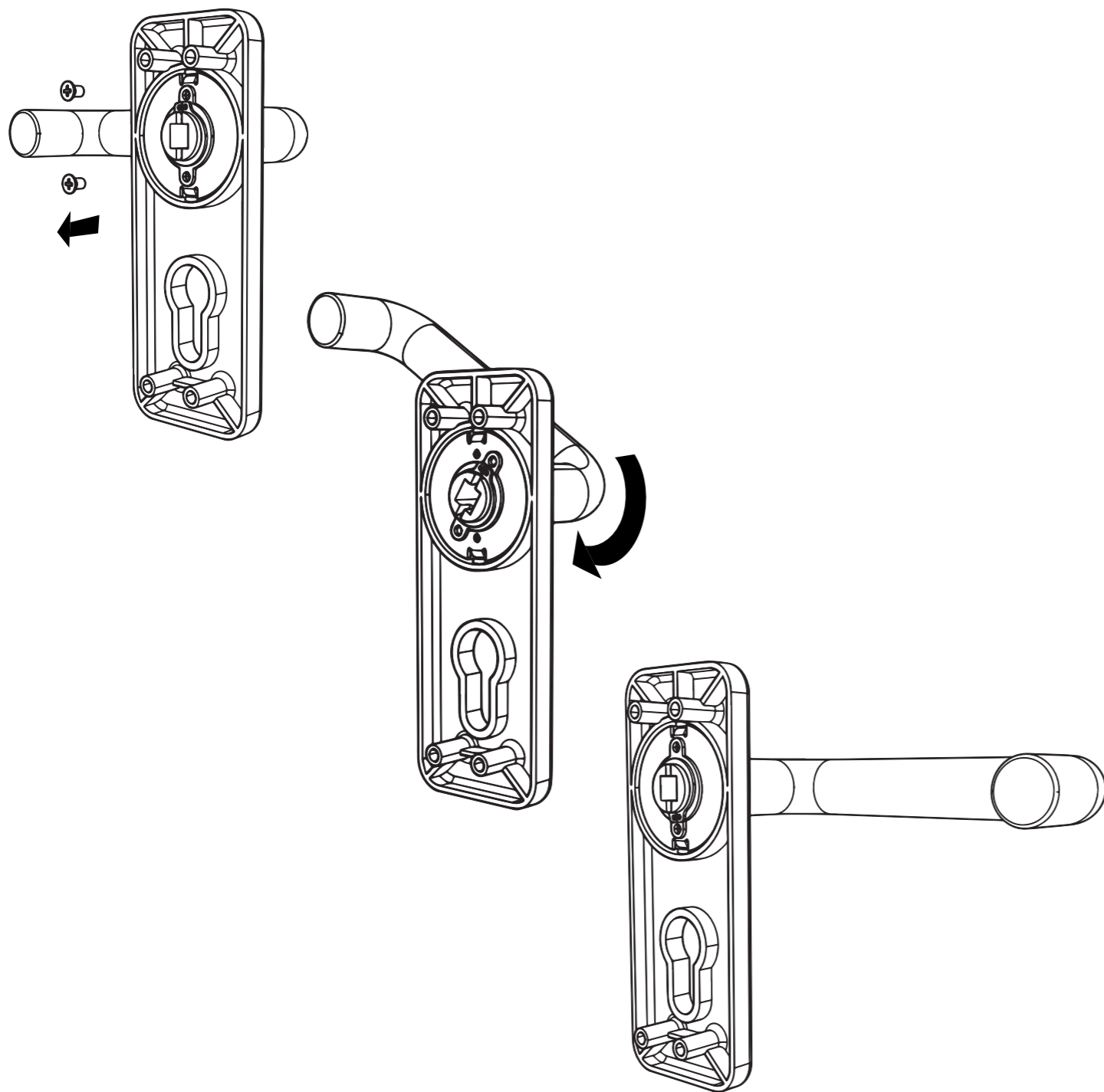

Remove the M3x5 screws from inside of the doorhandle and turn the handle.

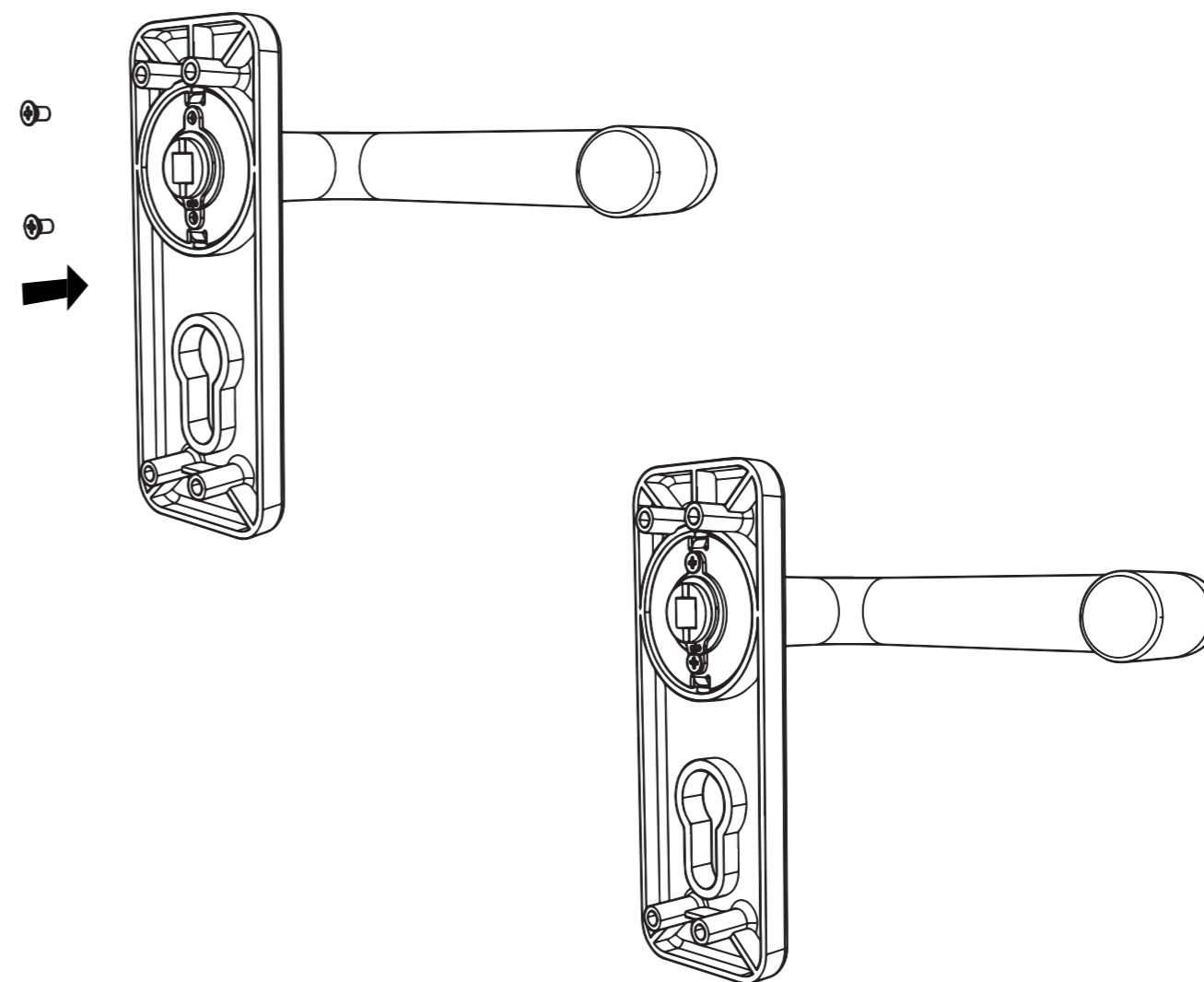

After turning the handle screw the M3x5 screws back to their original holes.

Frame Montage

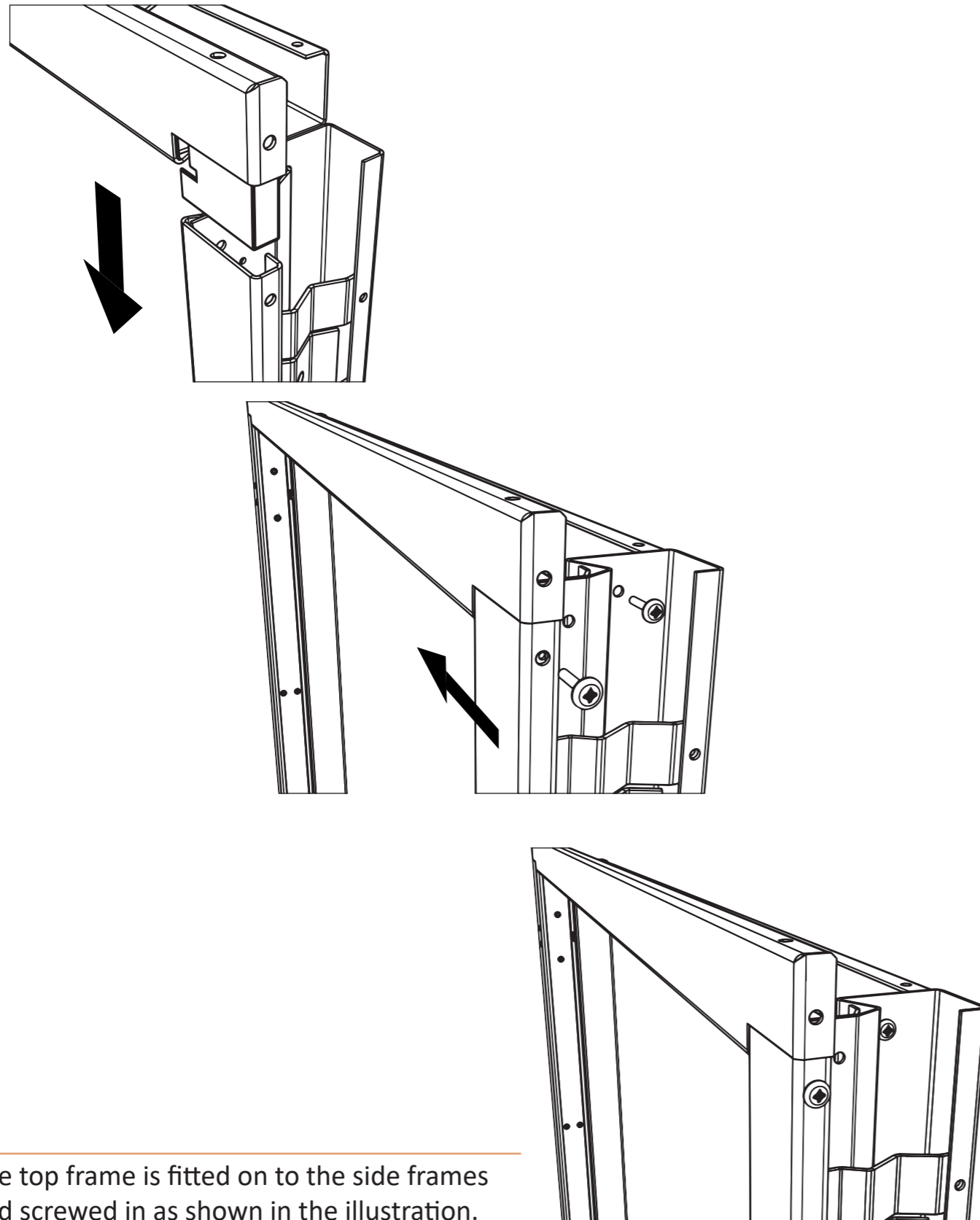

The top frame is fitted on to the side frames and screwed in as shown in the illustration.

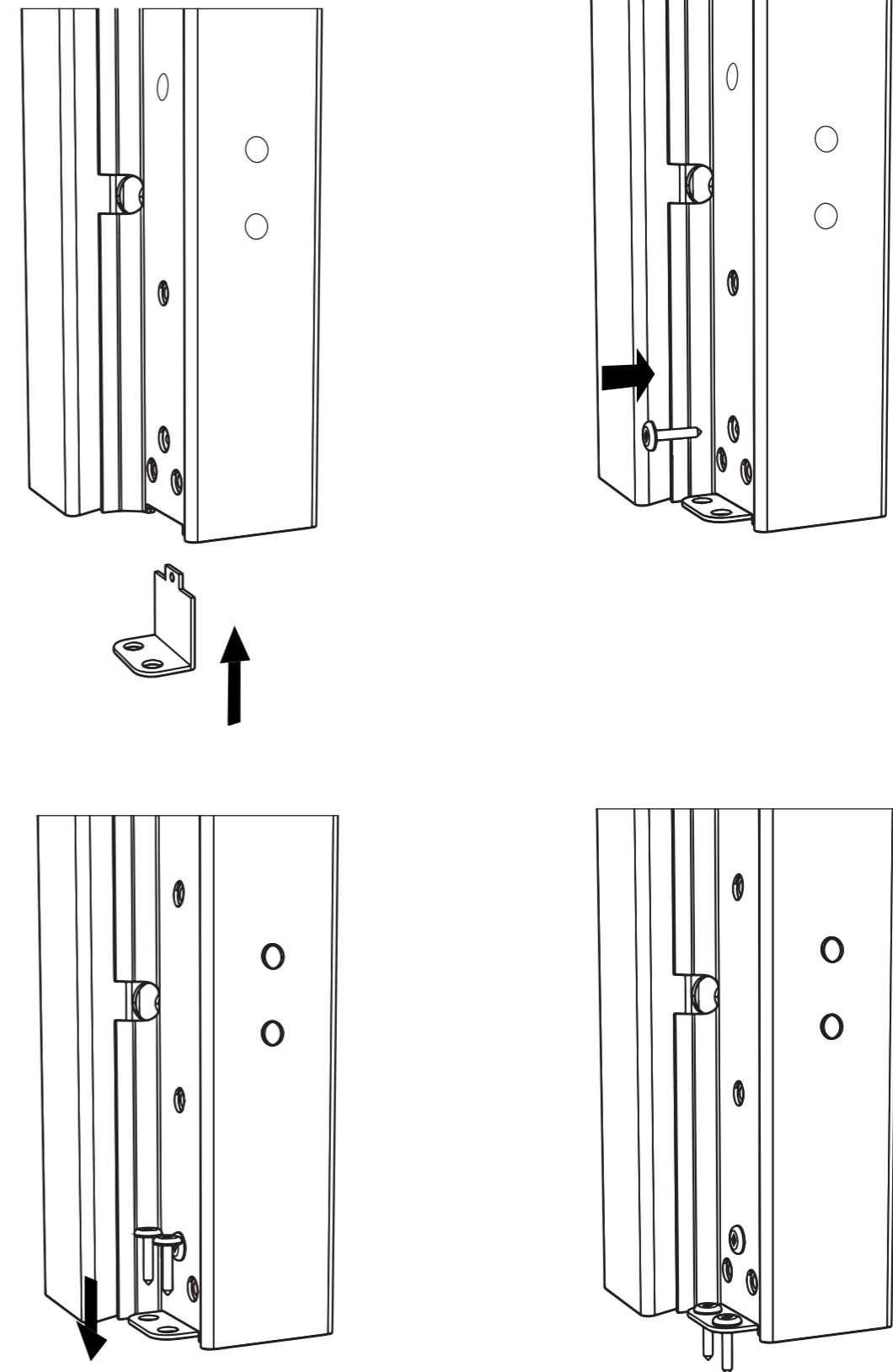

The frame floor montage bracket is mounted to the inside of the frame like shown in the illustration. After the frame is fitted on to the wall it is fixed to the floor with 2 screws.

Frame Montage

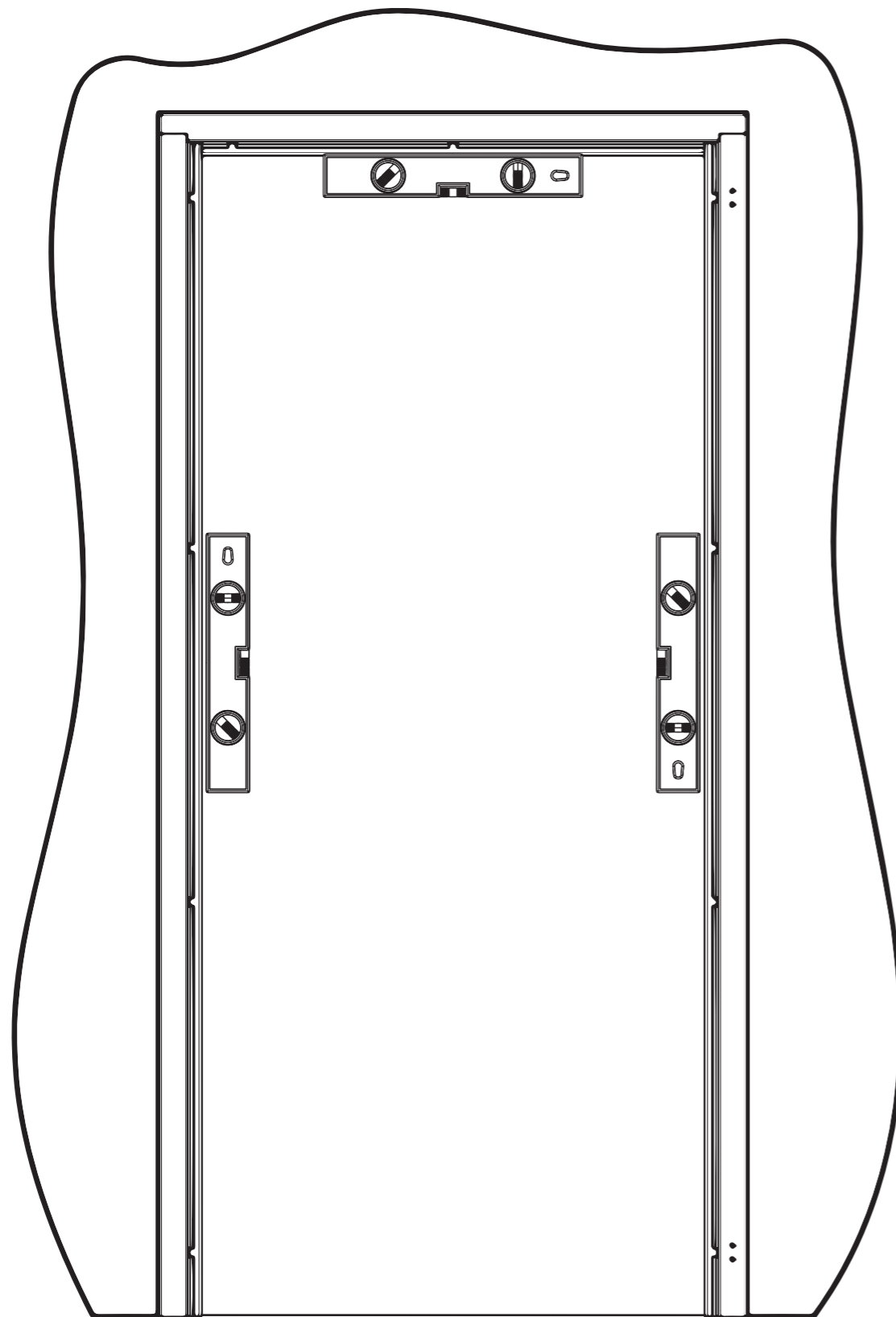

The frames that are going to be mounted to the wall is checked with a spirit level.

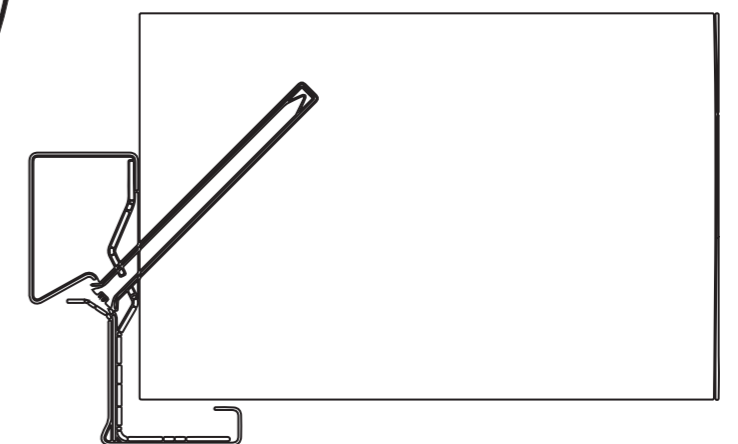
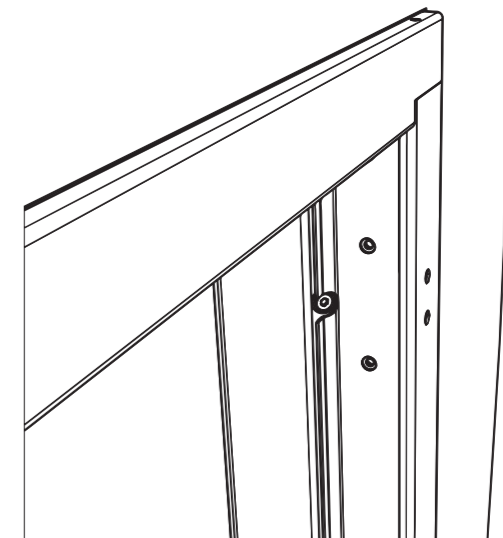
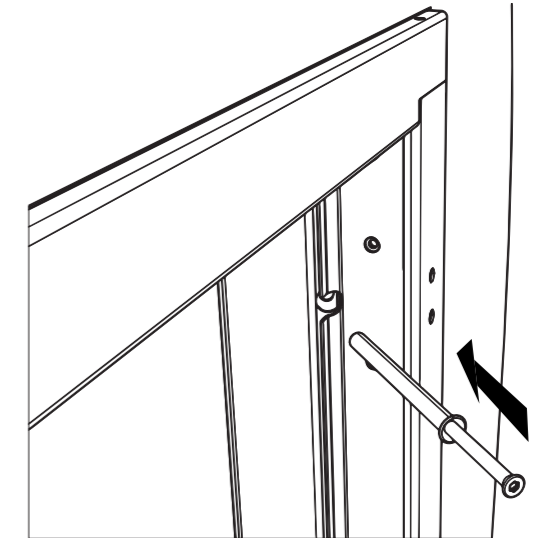
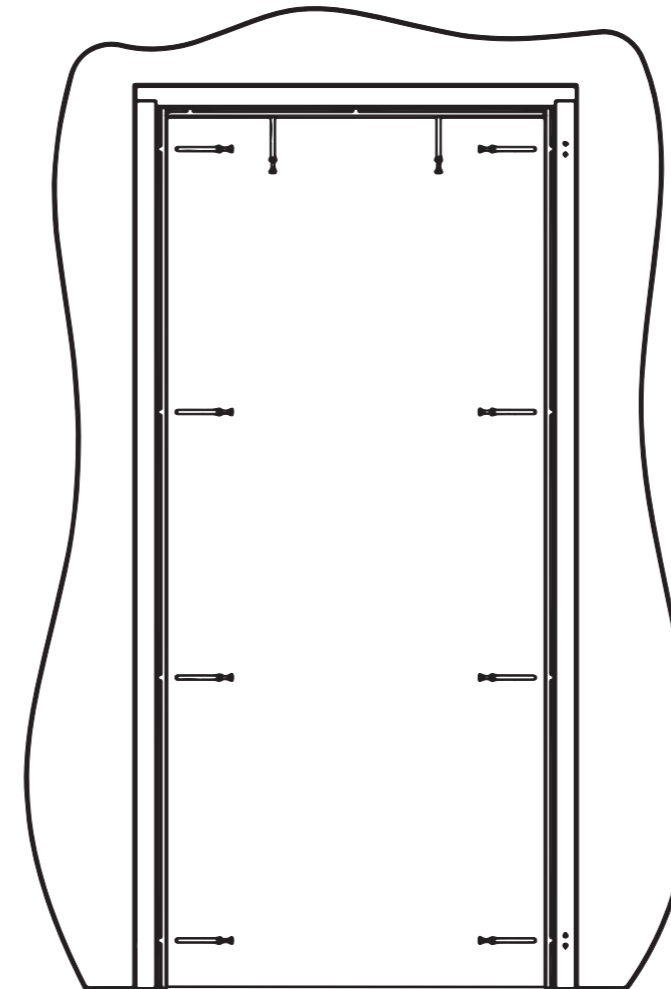

With a 8 point drill the places that dowels are going to be mounted is punctured and the dowels are drilled in with a 45 degree angle.

Leaf Montage

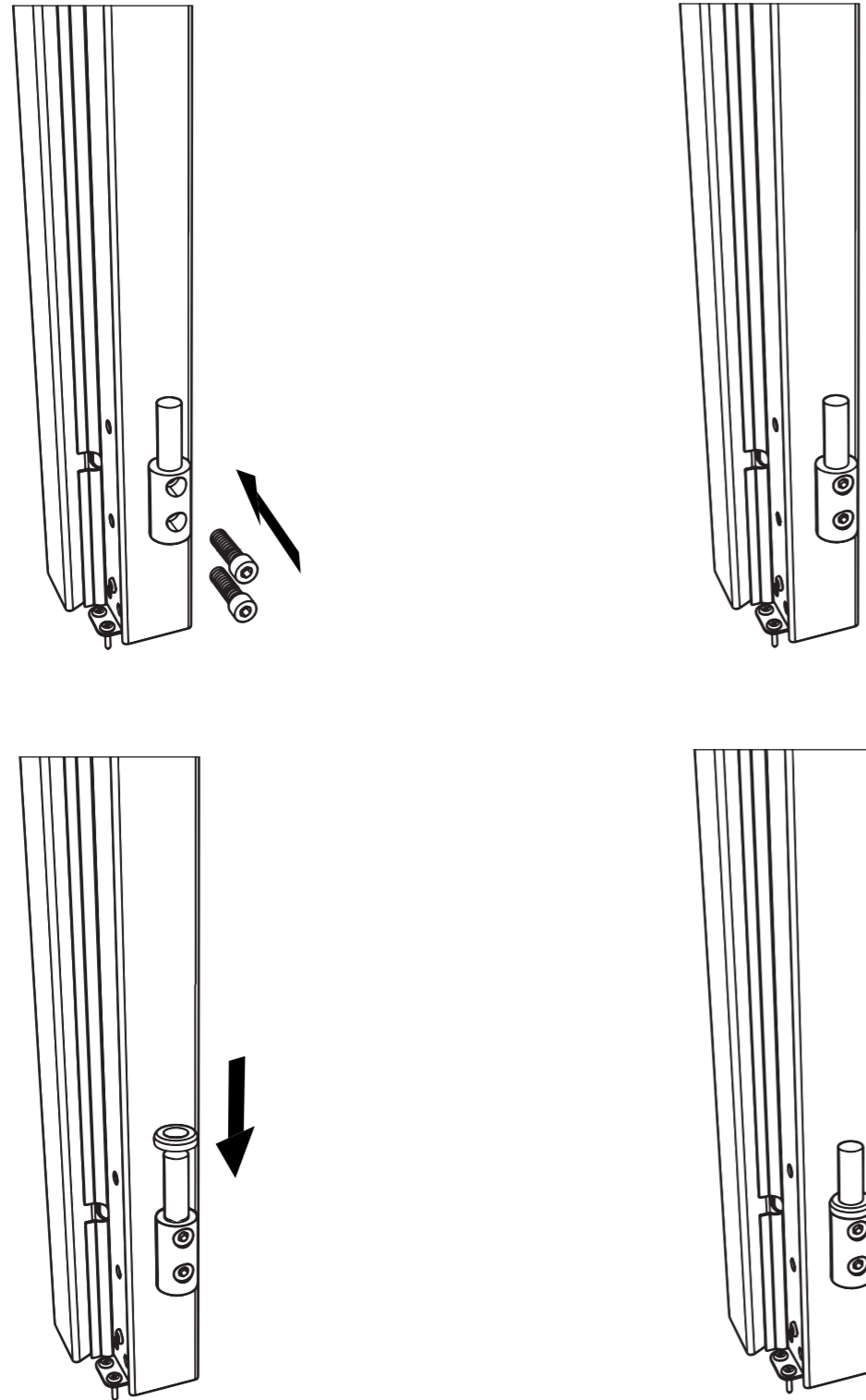

To fit the leaf first mount the bottom hinge on to the frame with the proper bolt and put on the ball-bearing.

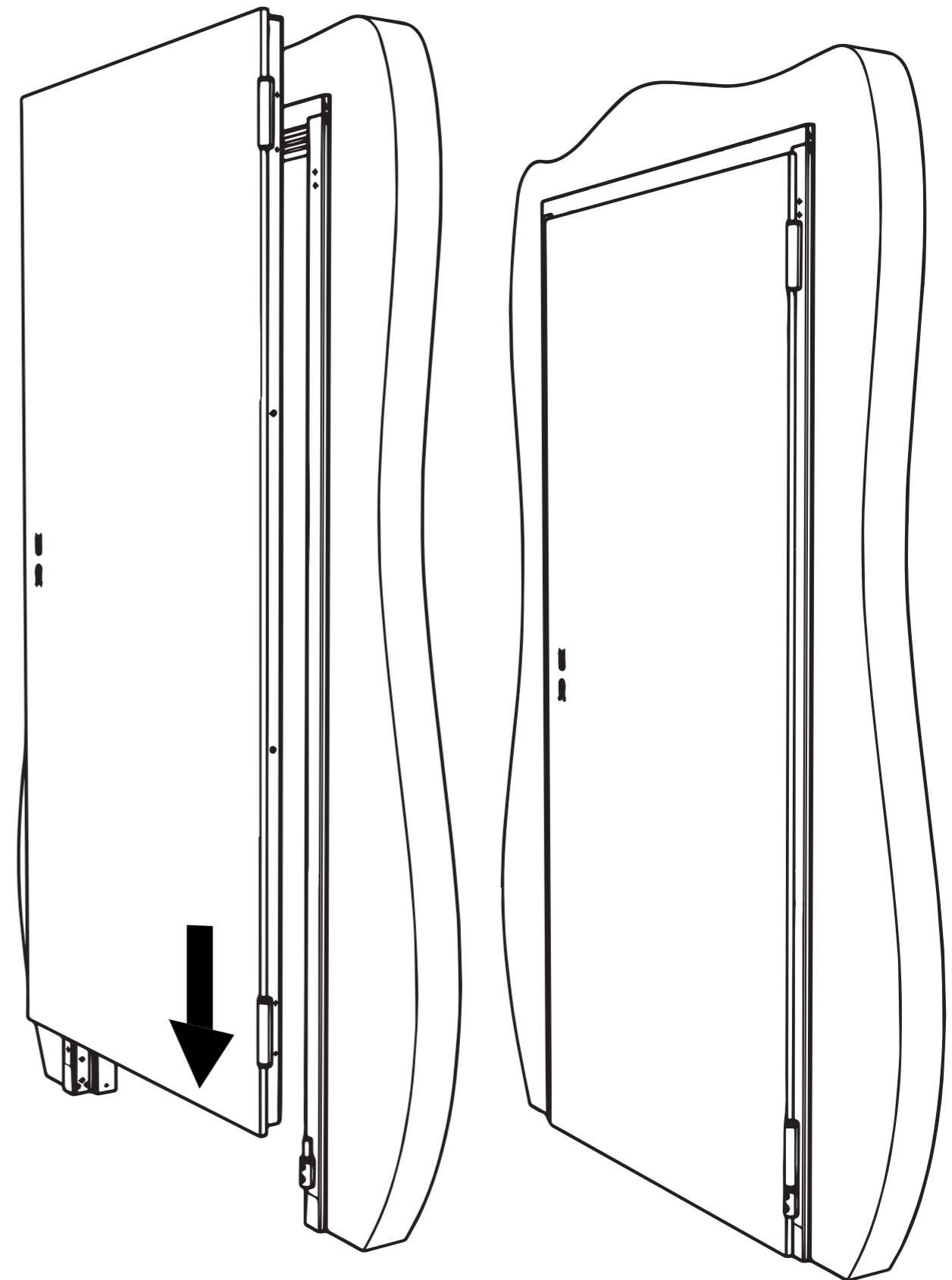

Place doorleaf on to the bottom hinge.

Leaf Montage

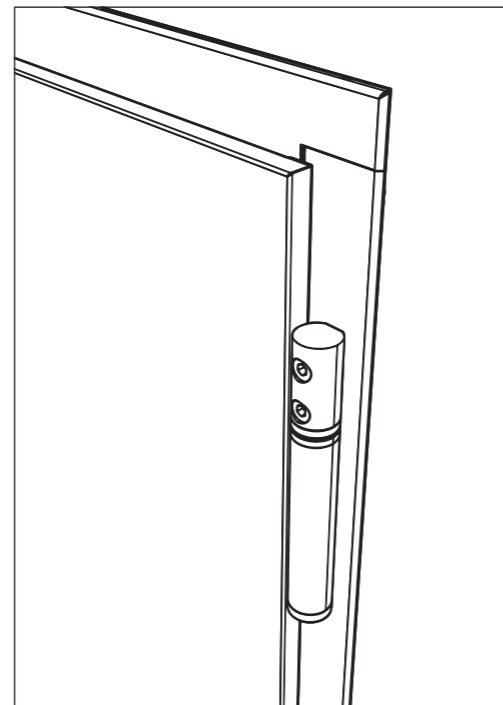
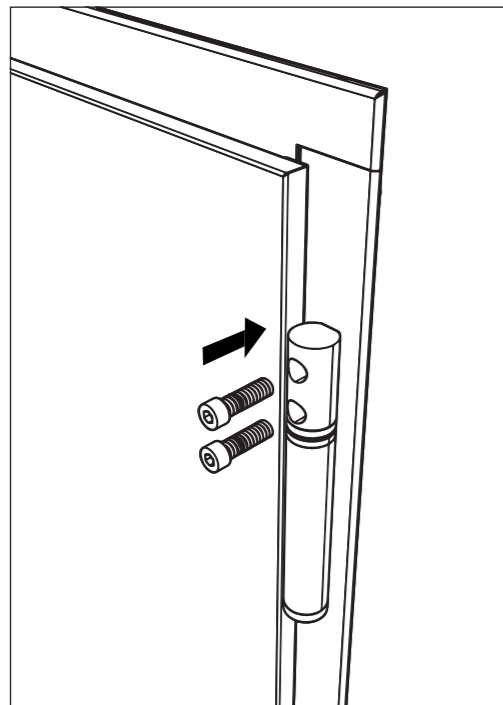
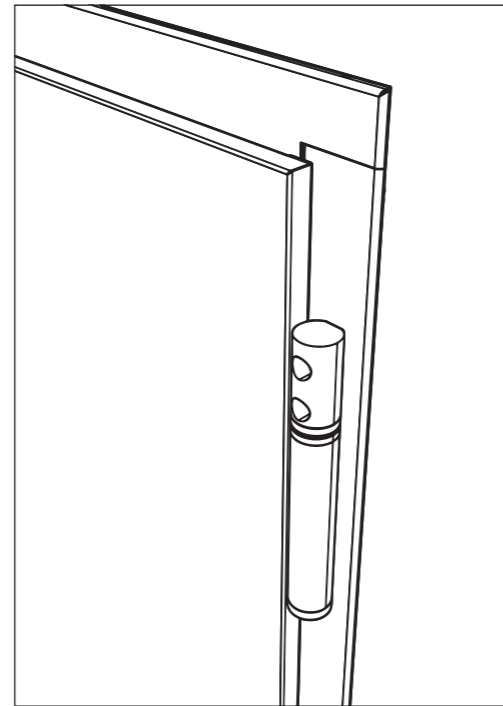
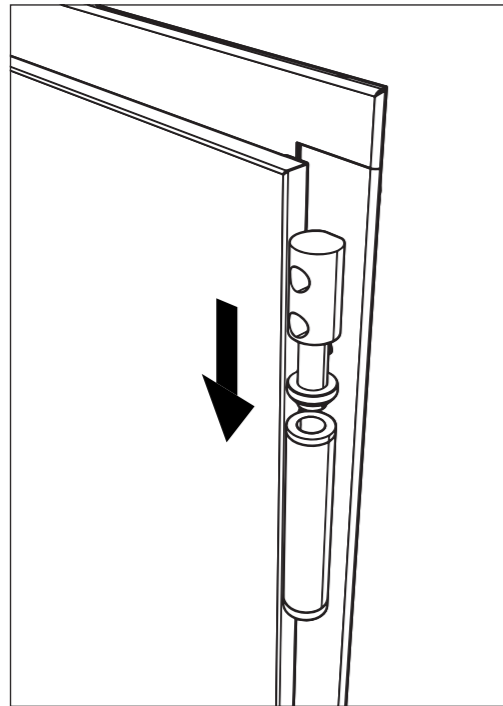

After mounting the leaf put the washer on to the top hinge and screw it on to the frame with the proper bolts.

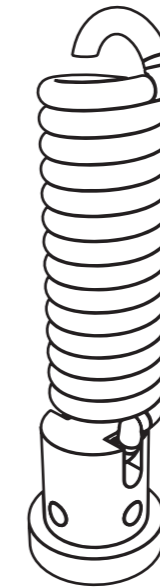
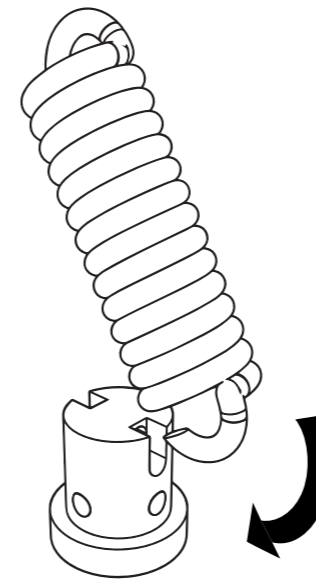

On right doors the spring is inserted into the top hinge, on left doors it is inserted into the bottom hinge!

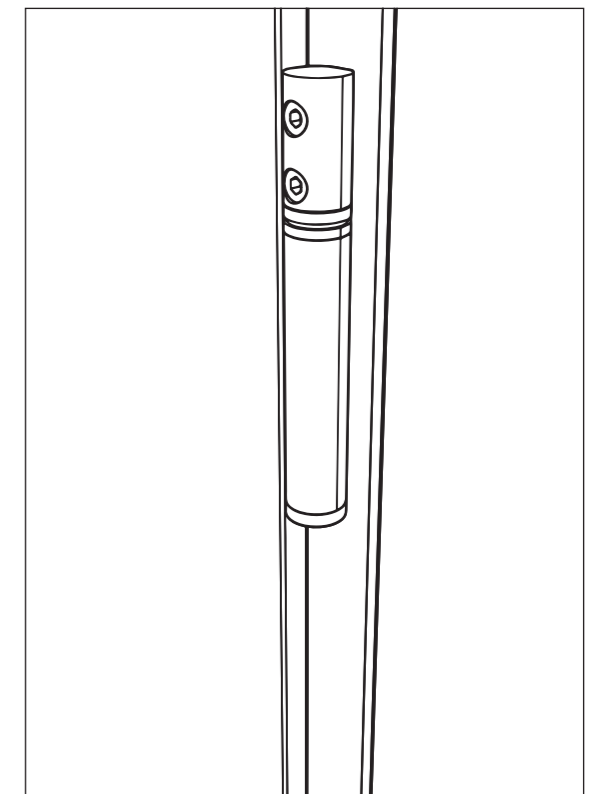
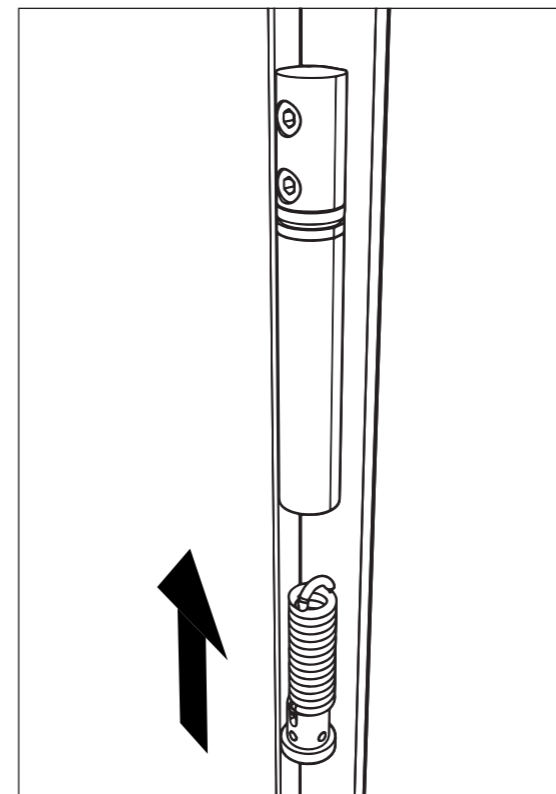

Mount the spring that will be put into the hinge and put it in to the hole and set it with an allen key and fix it with the pin.

Turning 'Anti-Panic' Lock to 'Panic' Lock

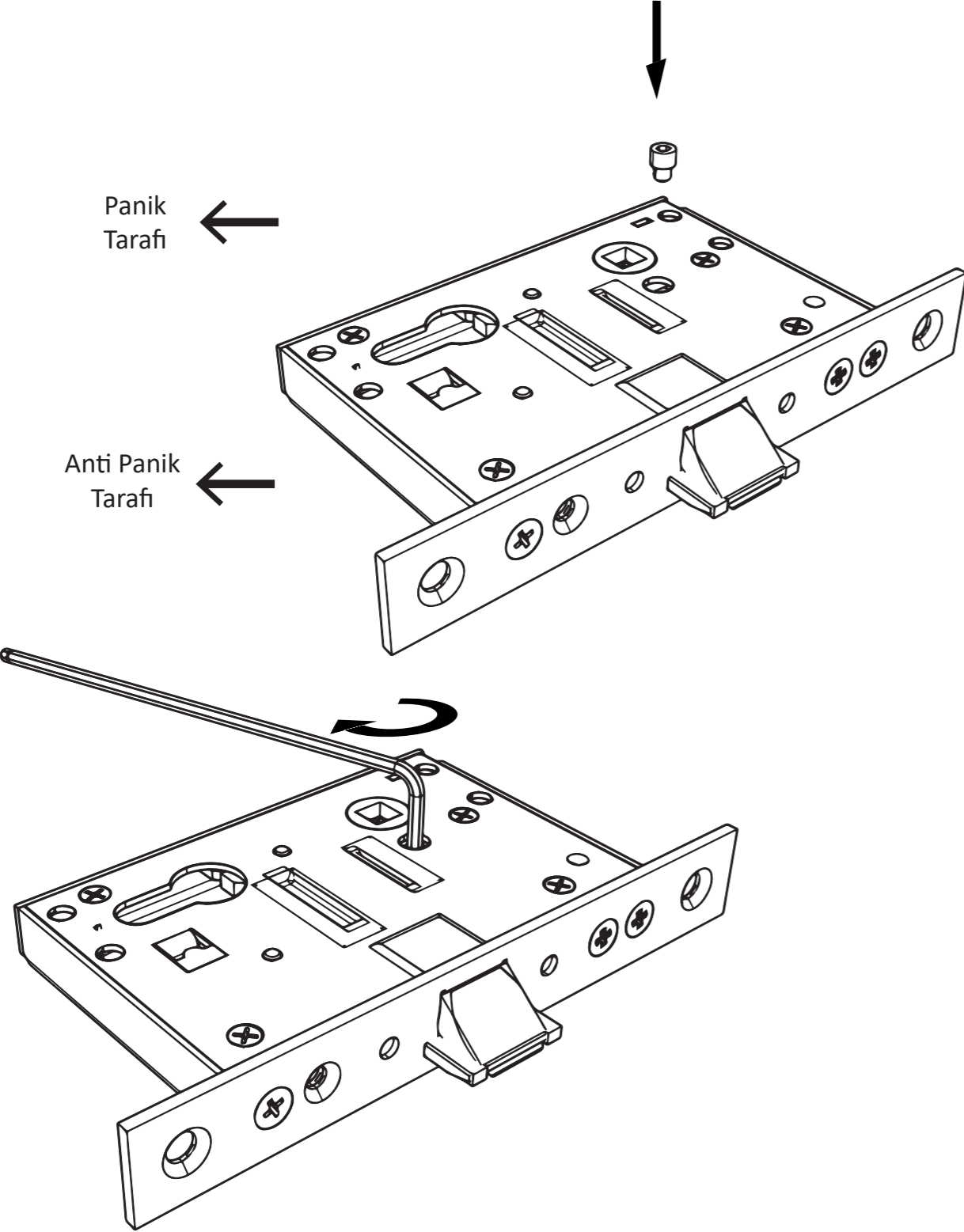

Place the M4 set screw in the screw hole on the lock and tighten with the proper allen key.

Assigning the Direction of the Lock

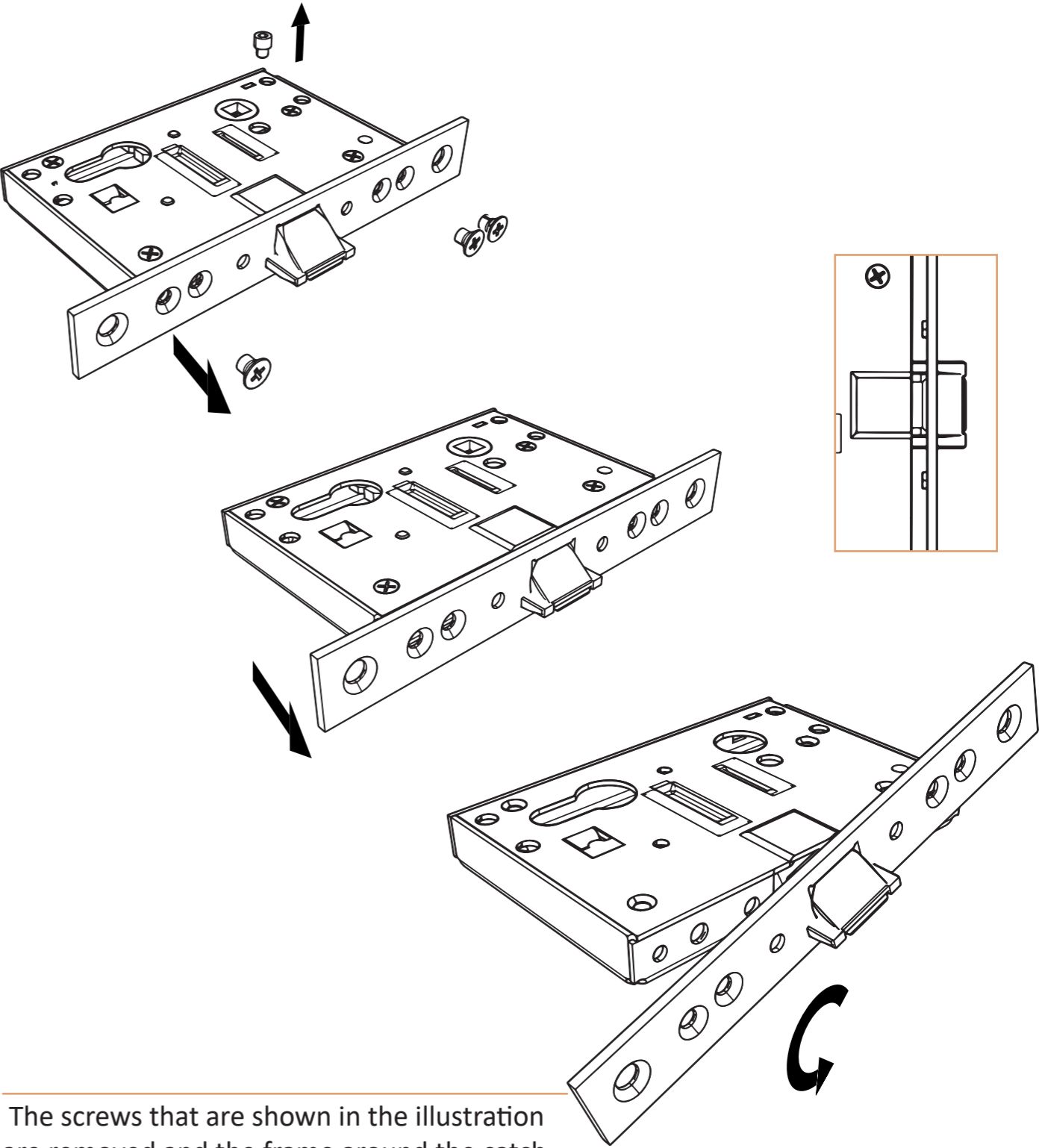

The screws that are shown in the illustration are removed and the frame around the catch is pulled out until it is out of its socket, then turned around.

Assigning the Direction of the Lock

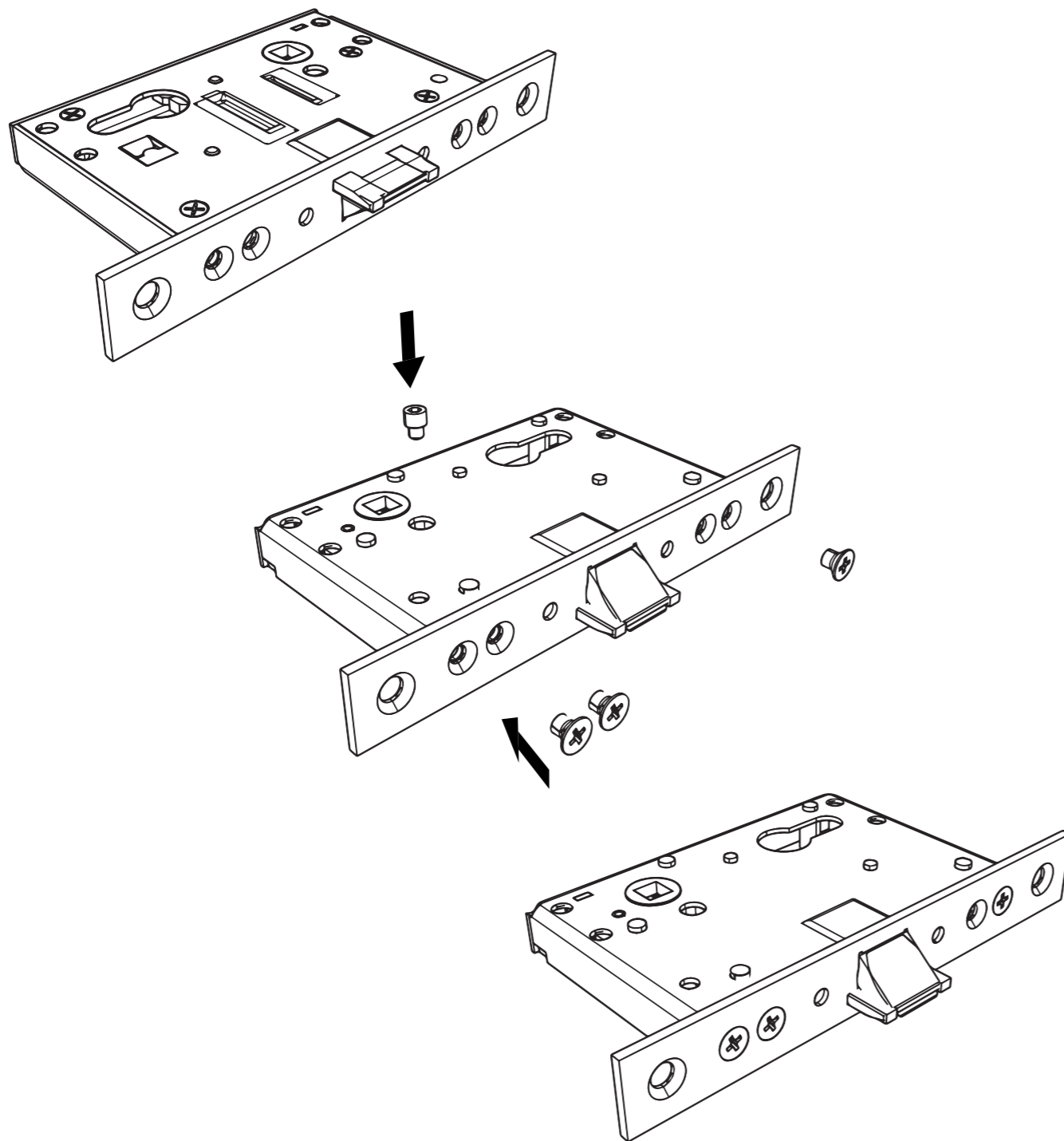

The lock is then turned around to the face that the catch is inclined, and the screws are screwed in to their places as shown in the illustration.

Lock Montage

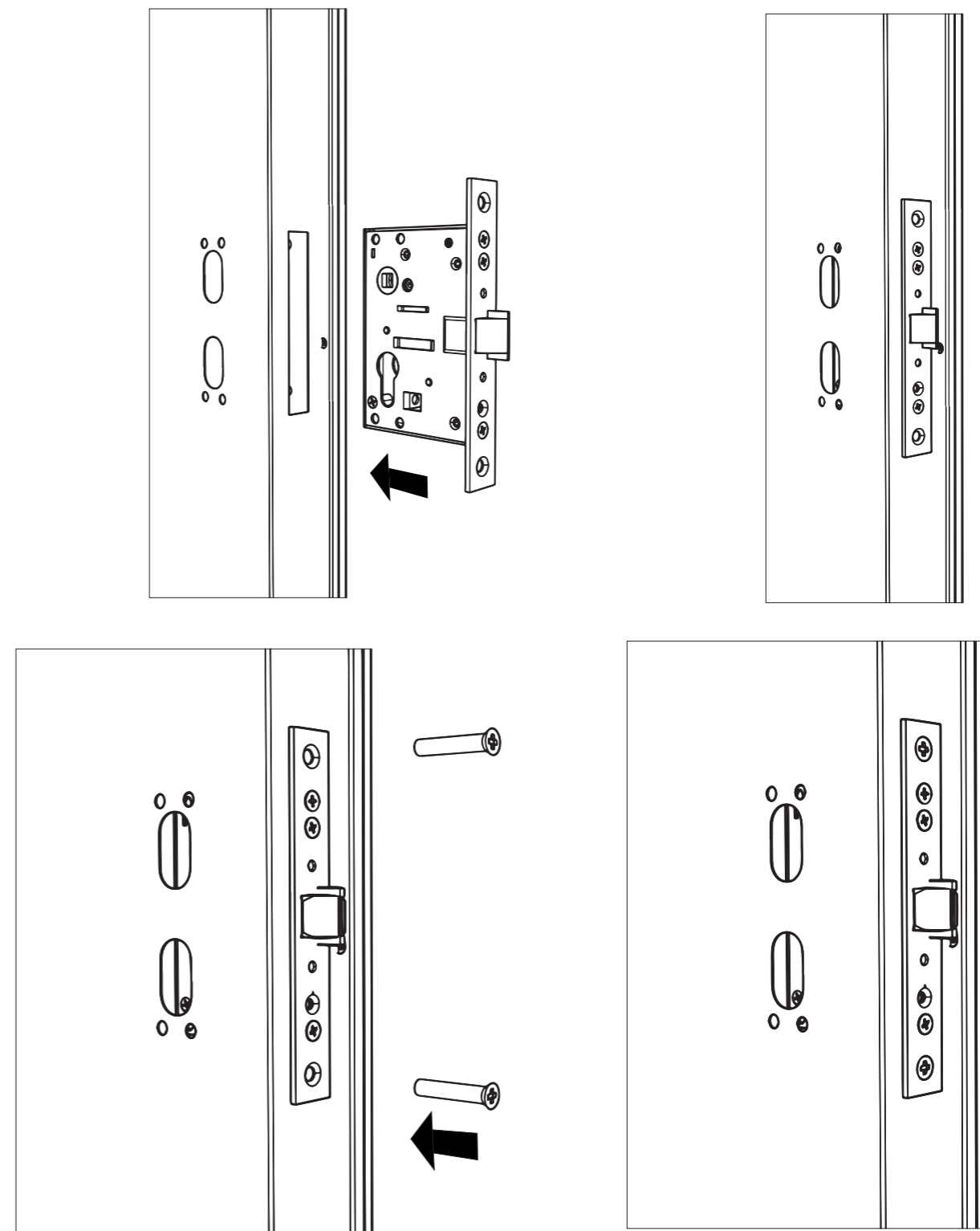

The lock is put into its socket and screwed in.

Lock Montage

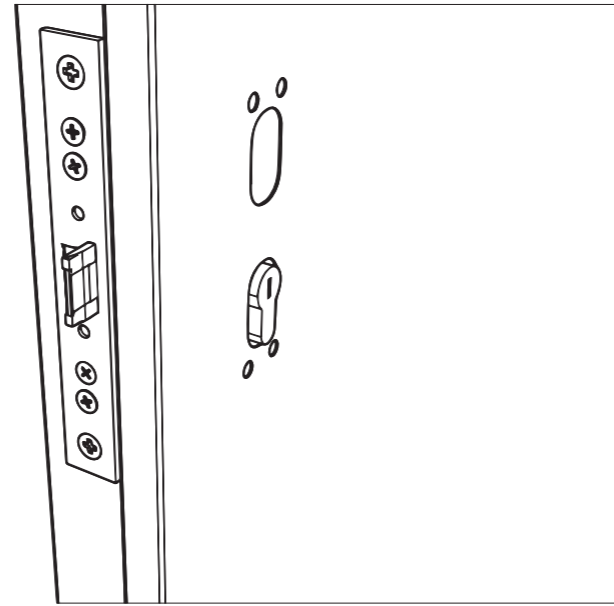
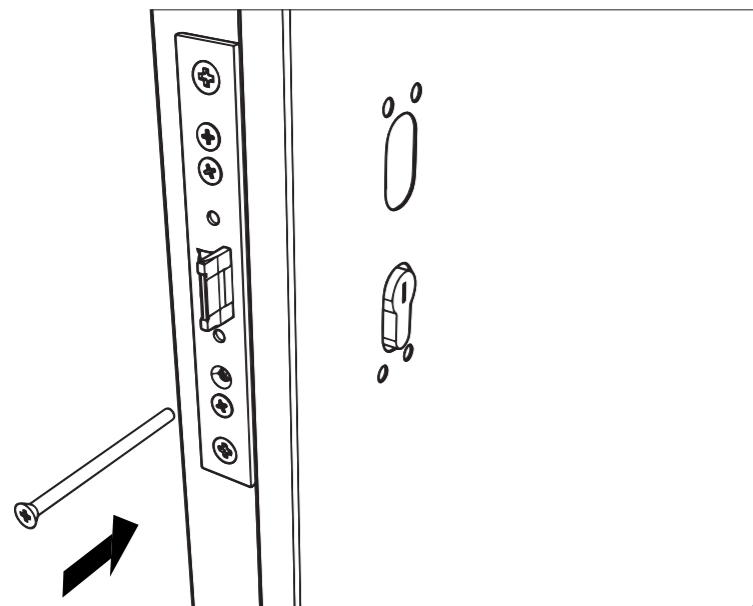
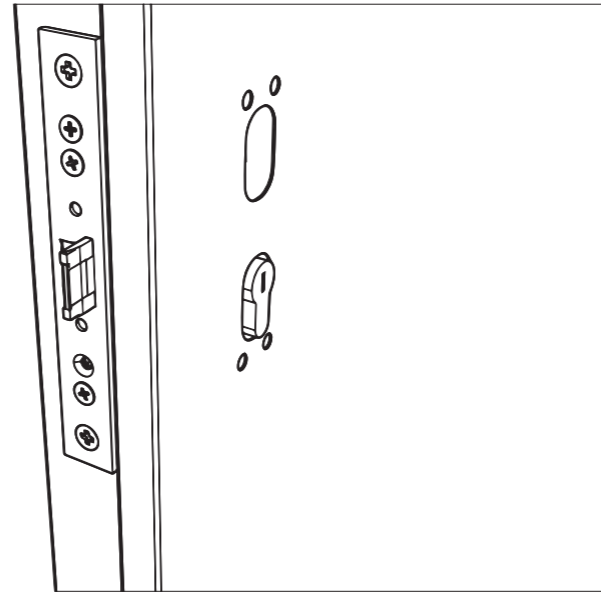
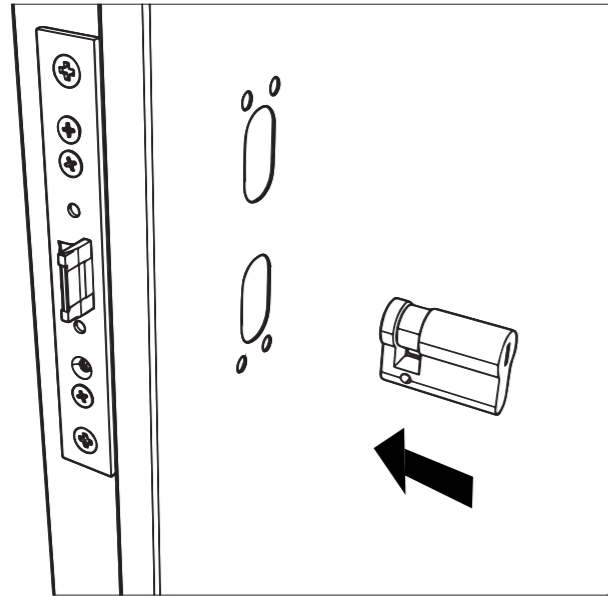

After fixing the lock in, the cylinder is inserted from the outer side of the door and is fastened with the cylinder screw supplied.

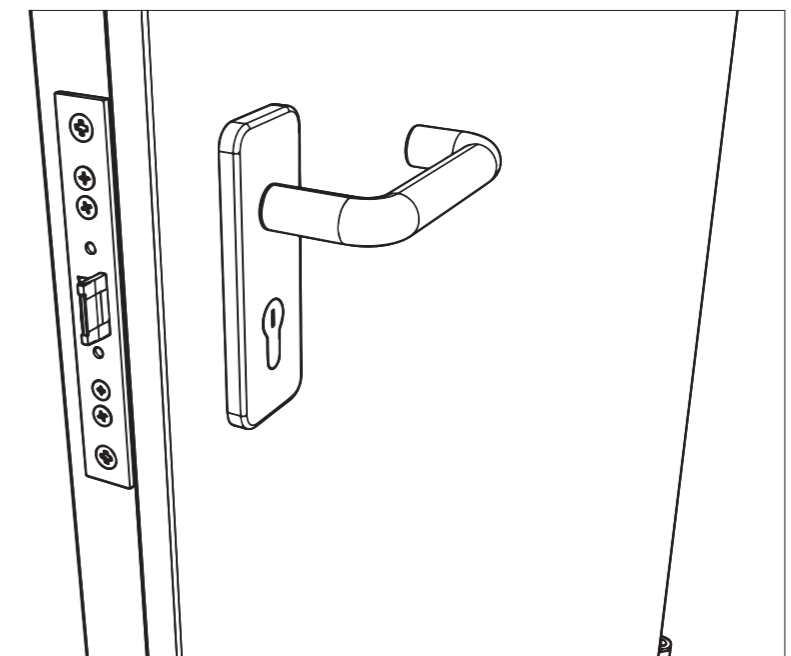
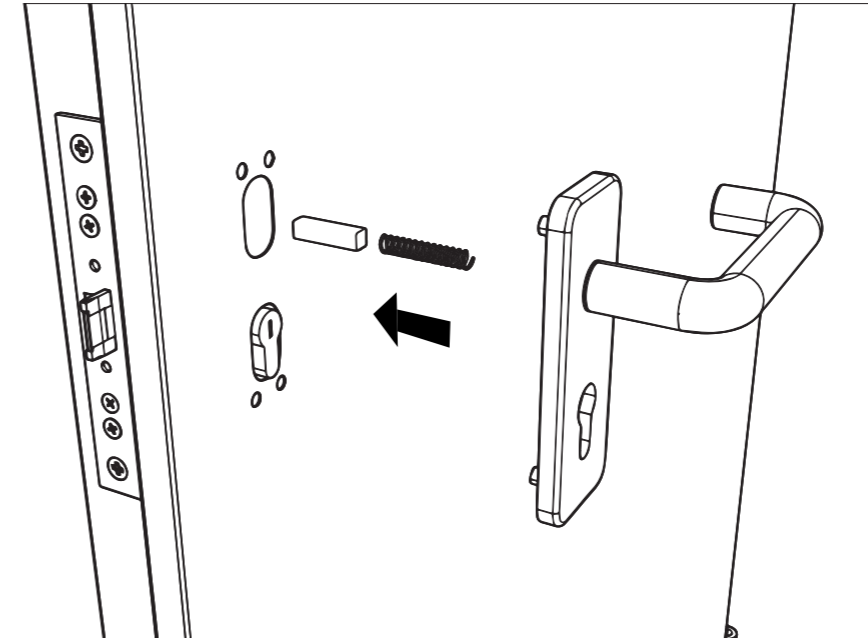

Insert alternately the spring and the 52mm square key into the handle, then place the handle on the door.

Panic Bar Montage

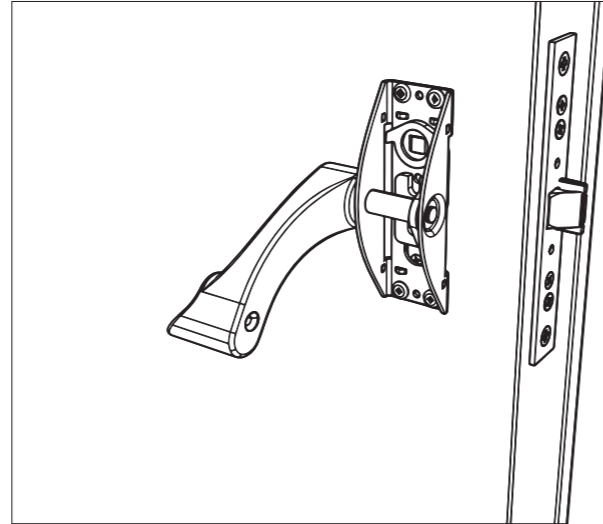
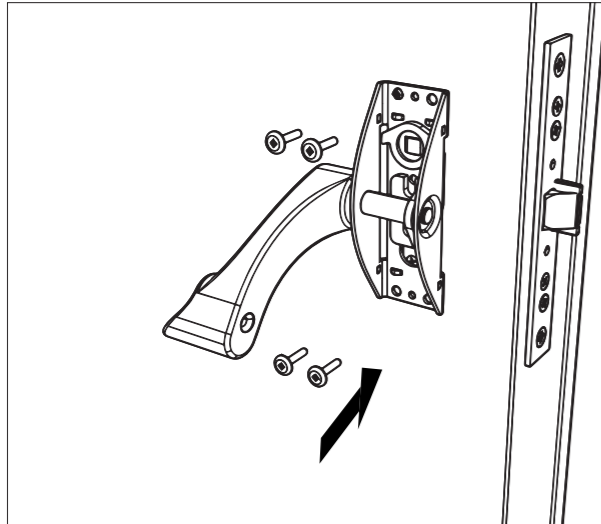
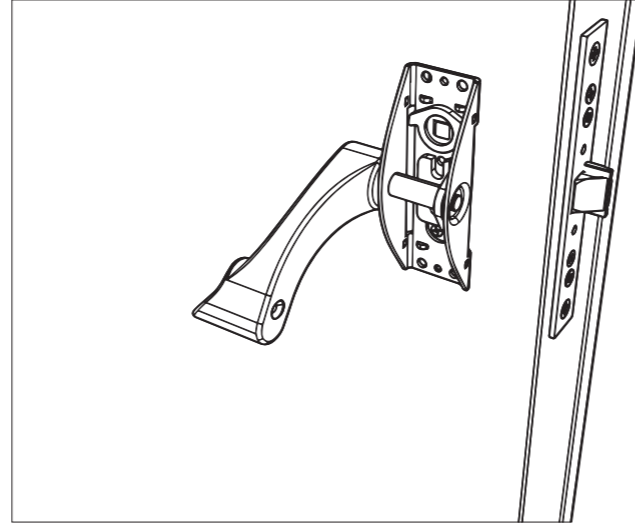
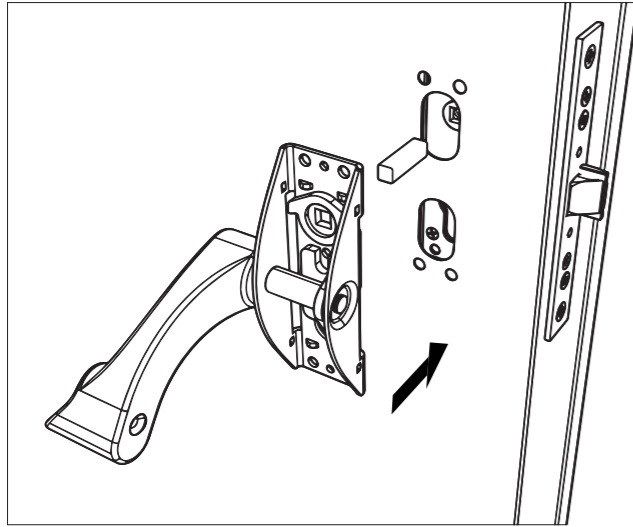

From the inner side of the door place in the 32 mm square key and screw in.

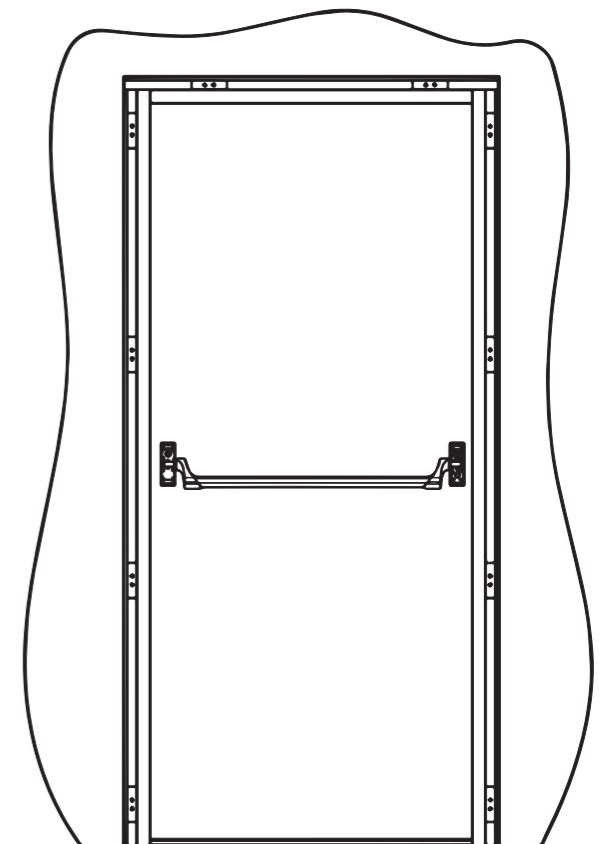
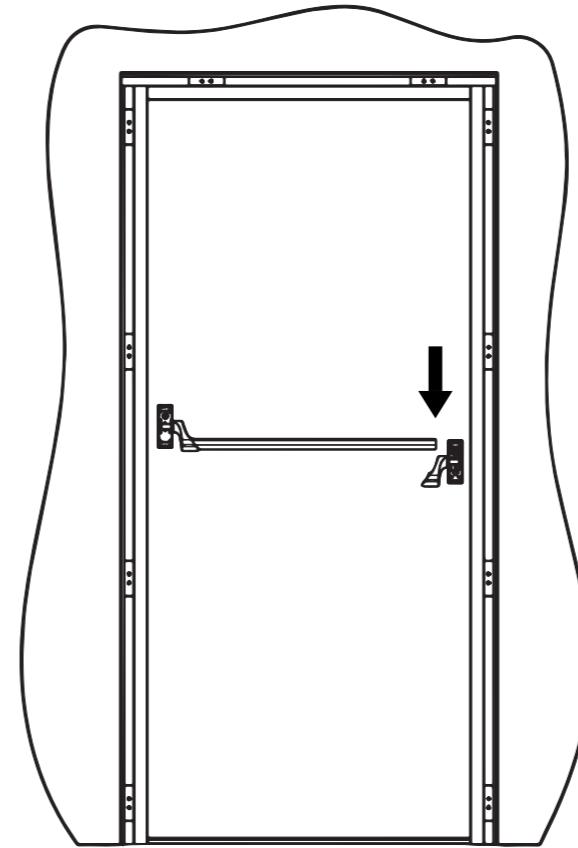

Put through the rest of the panic bar in the mounted part.

Panic Bar Montage

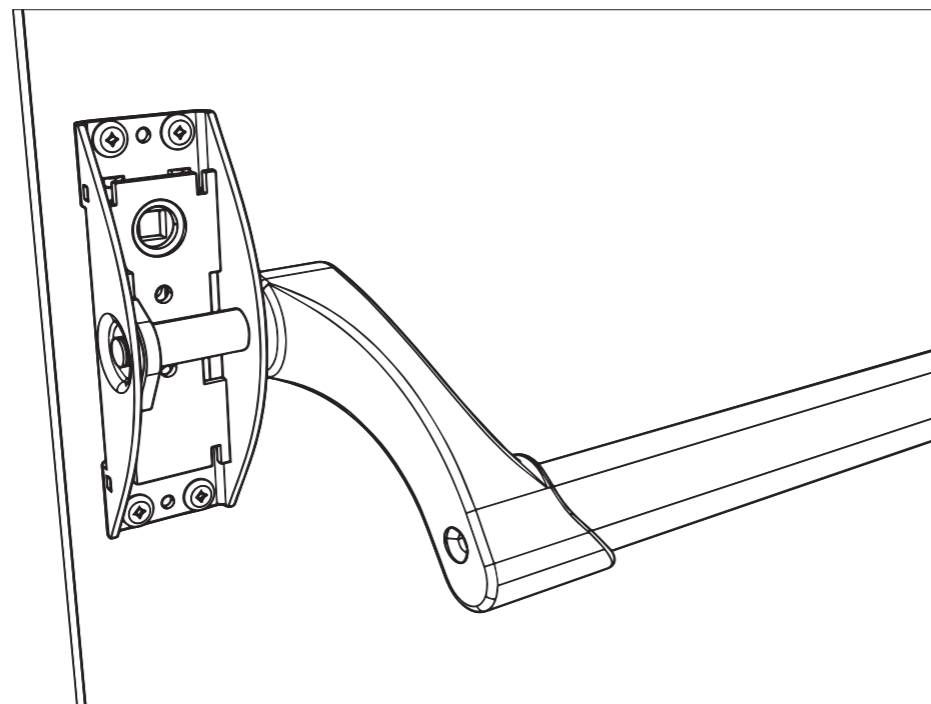
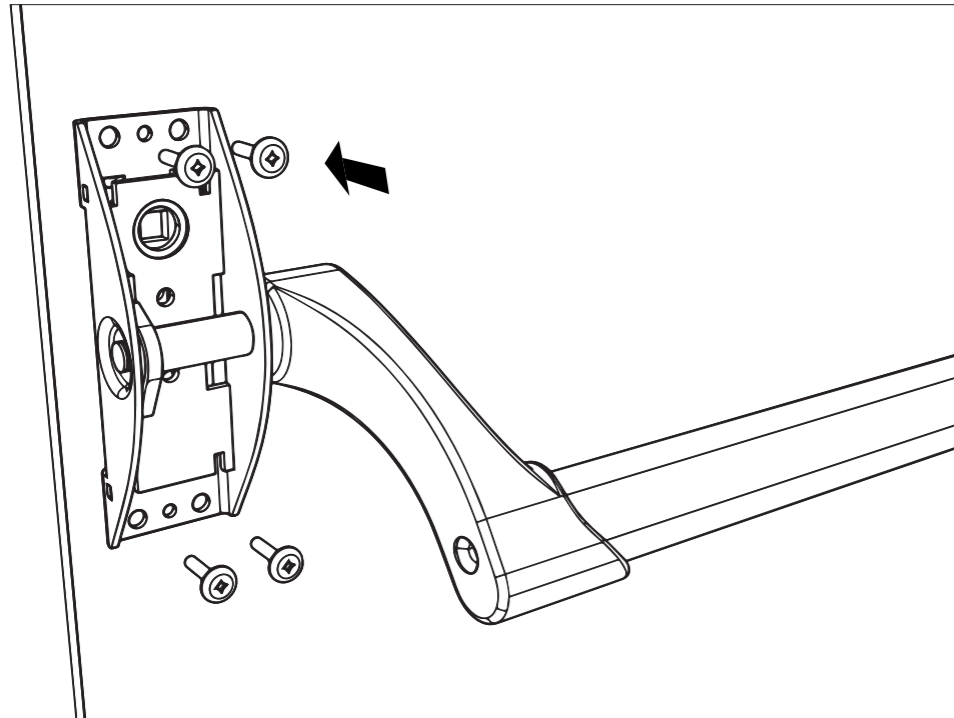

Then screw on the other handle.

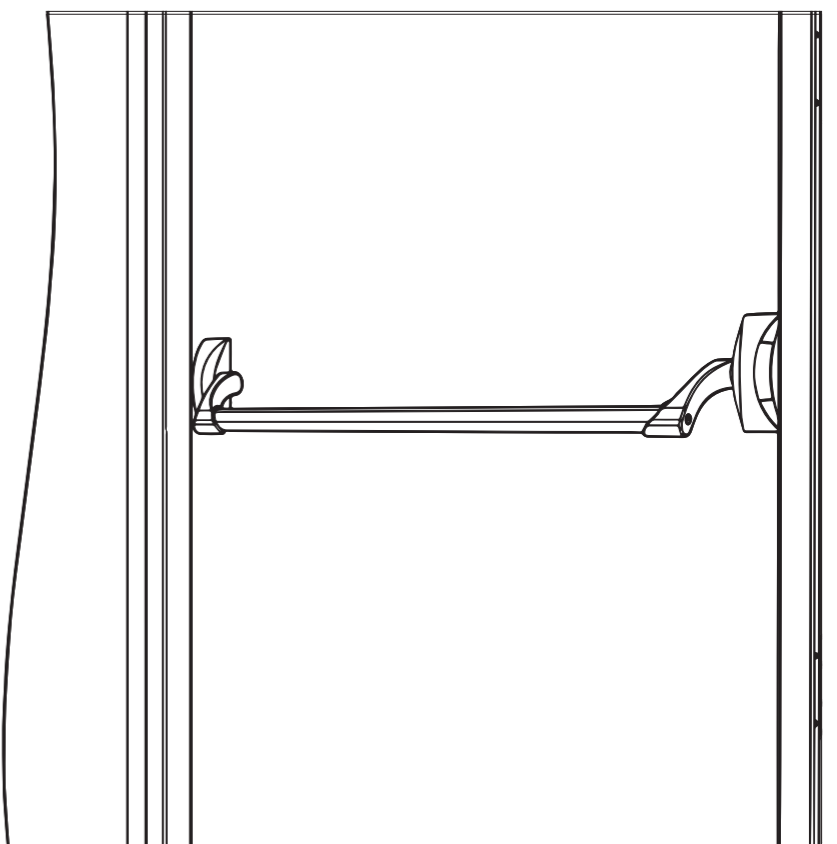
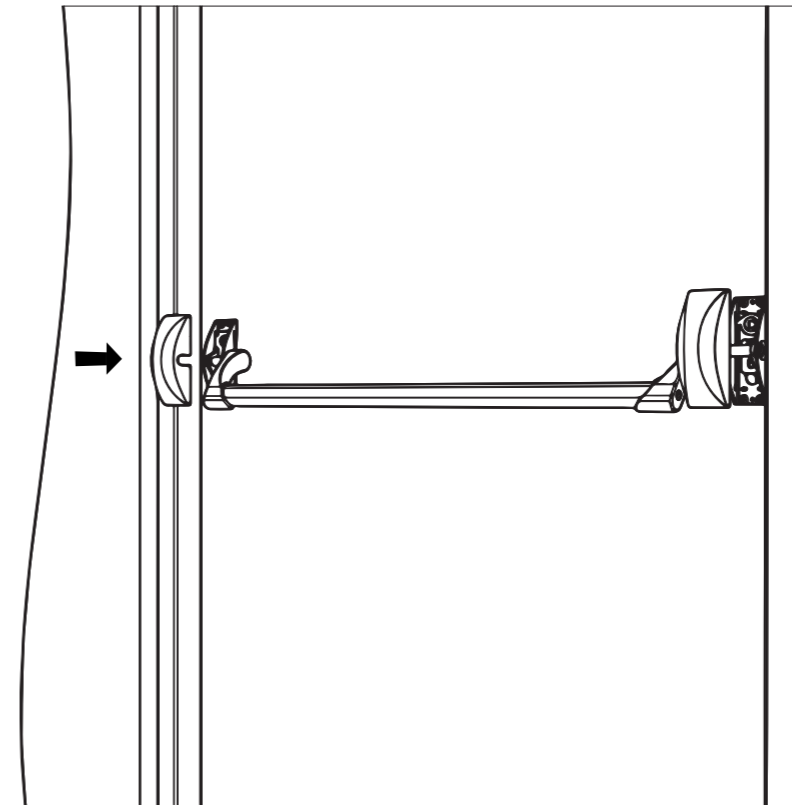

After you montaged everything put on the panic bar caps and the assembly is finished.

Double Doorhandle Montage

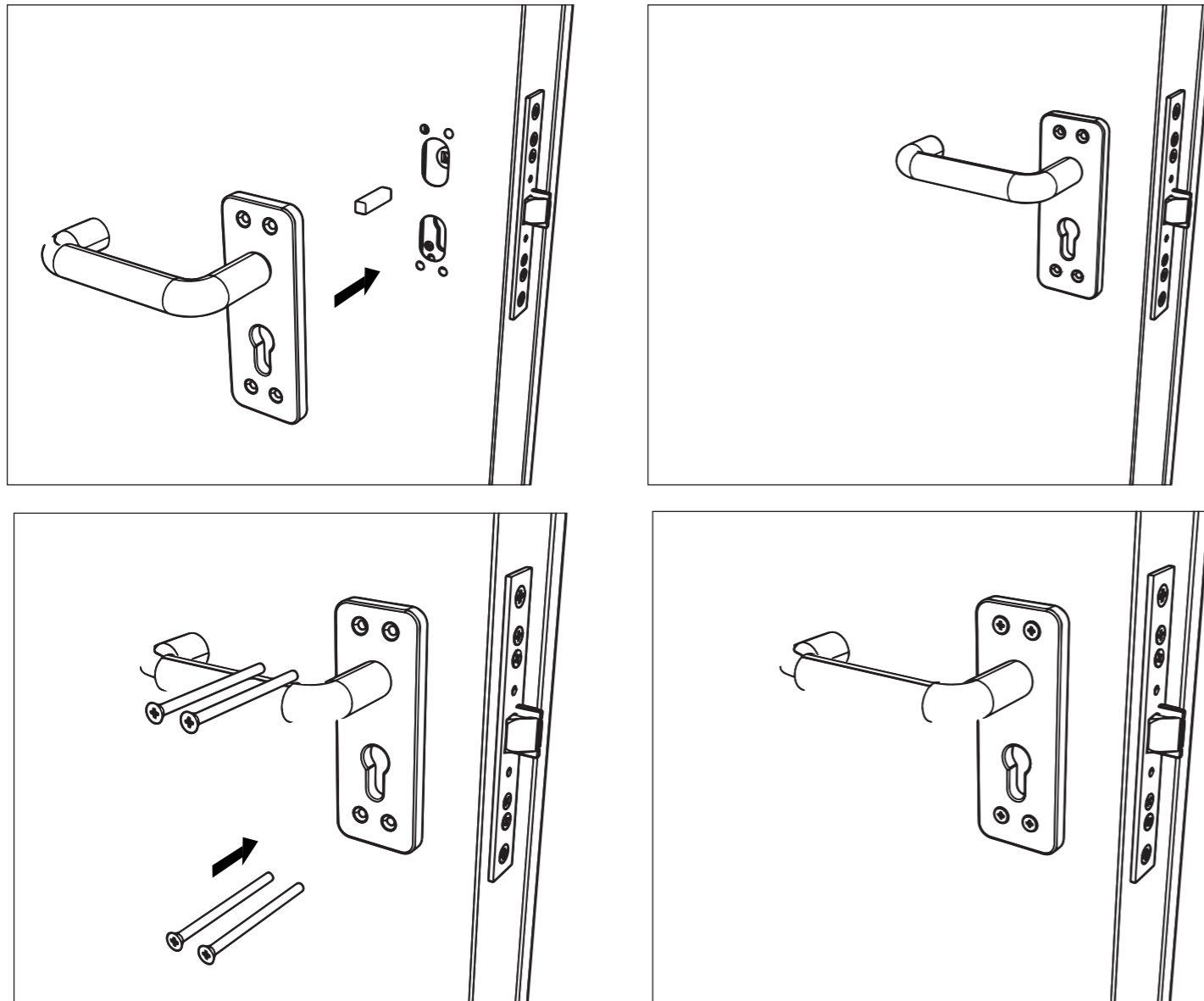

Put on the doorhandle to the inner side of the door and screw on.

Intumescent Seal

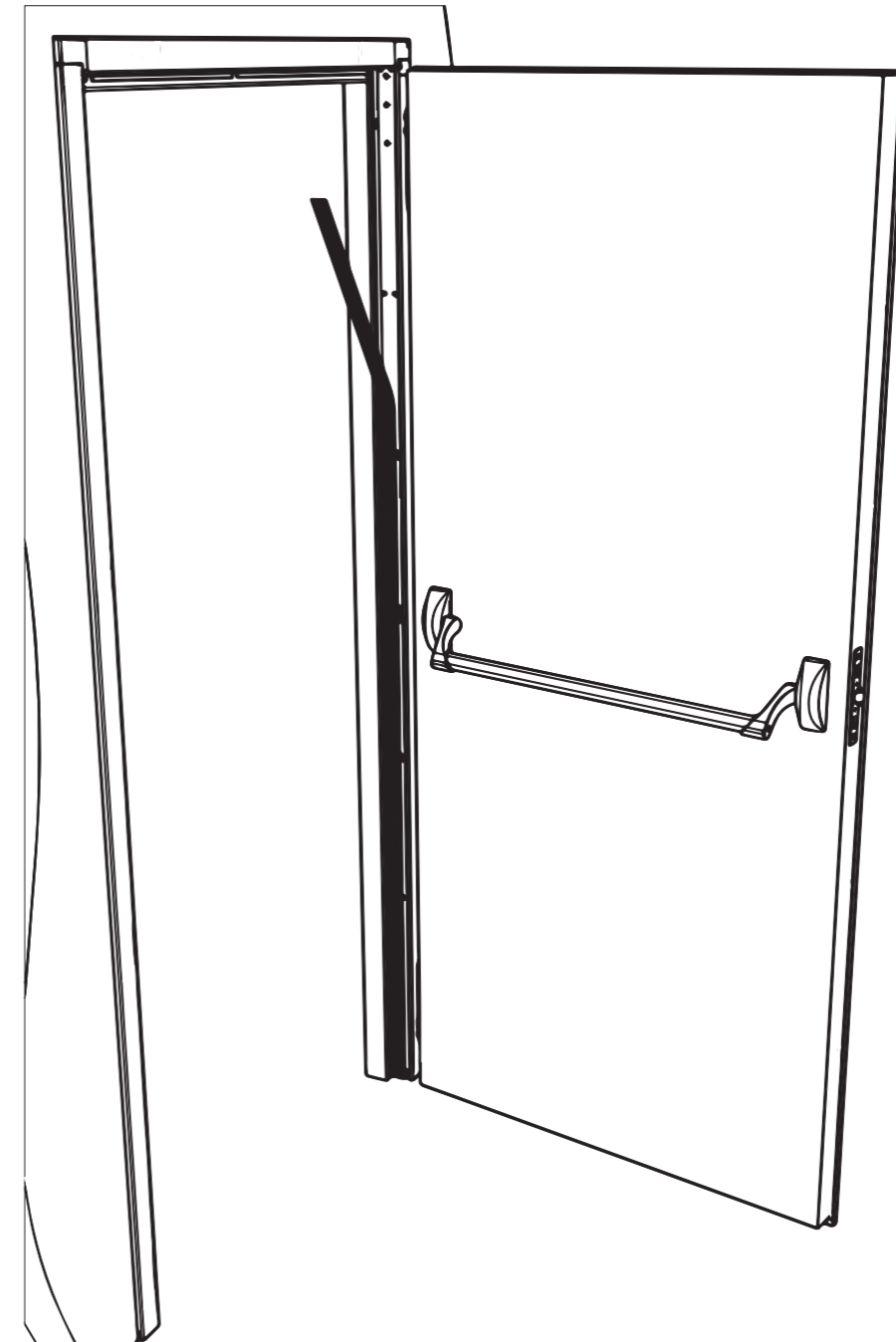

Finally apply the intumescent seal on all of the inner faces of the frame, as shown in the illustration.

Full Frame Montage

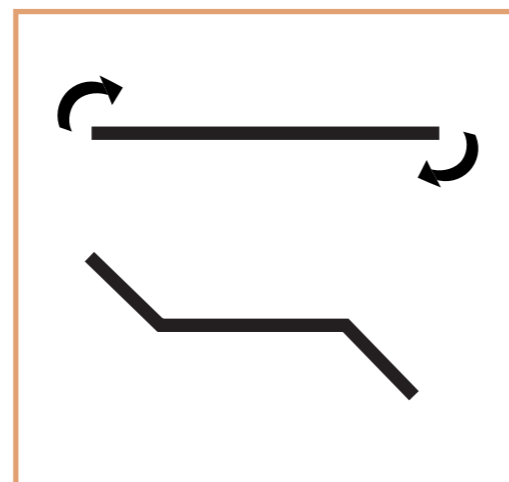
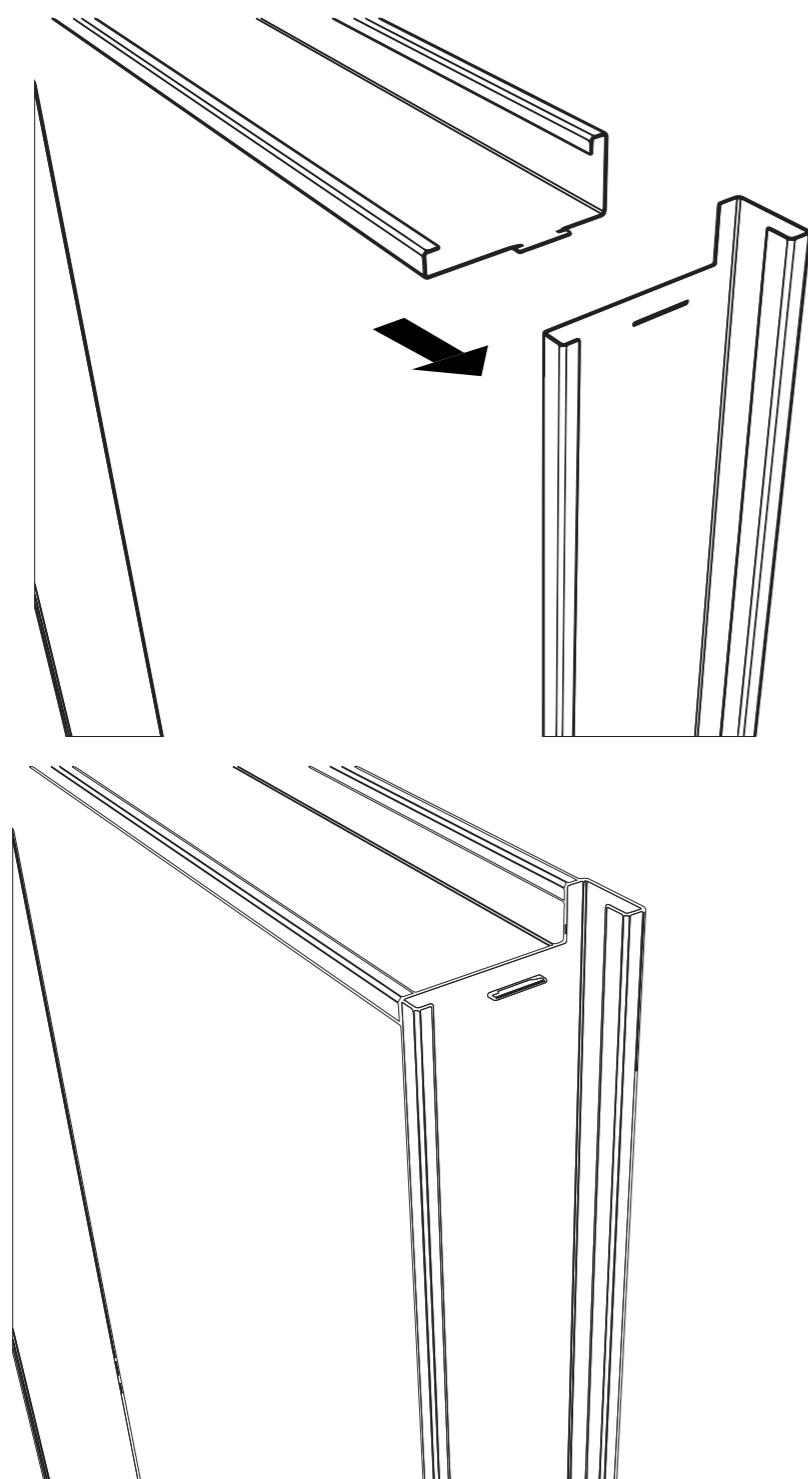

The top part of the full frame part is fitted to the side parts by putting the notch through the pocket, then twist the notch as shown in the illustration.

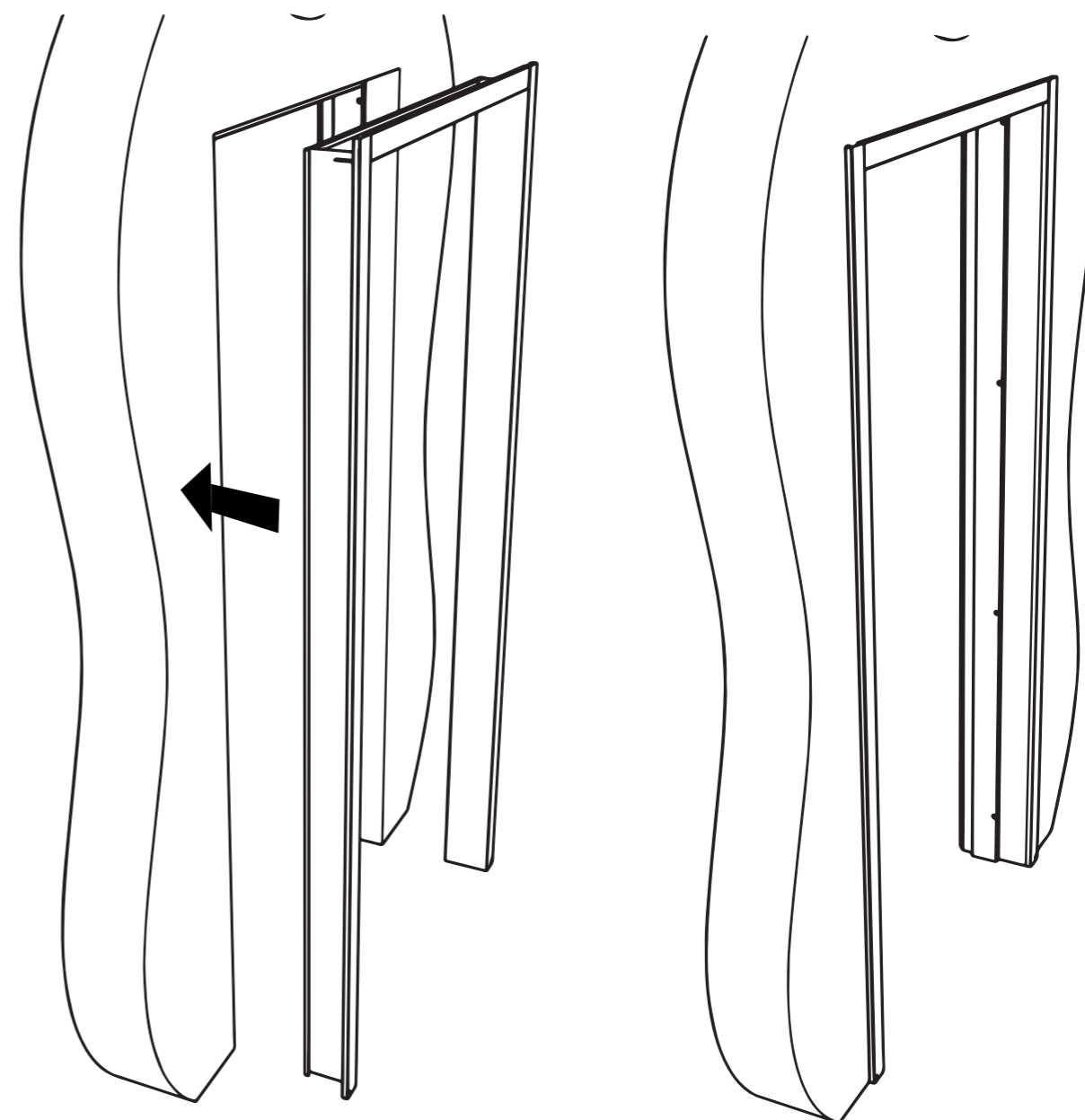

Put the full frame part inside the fixed frame on the wall.

Full Frame Montage

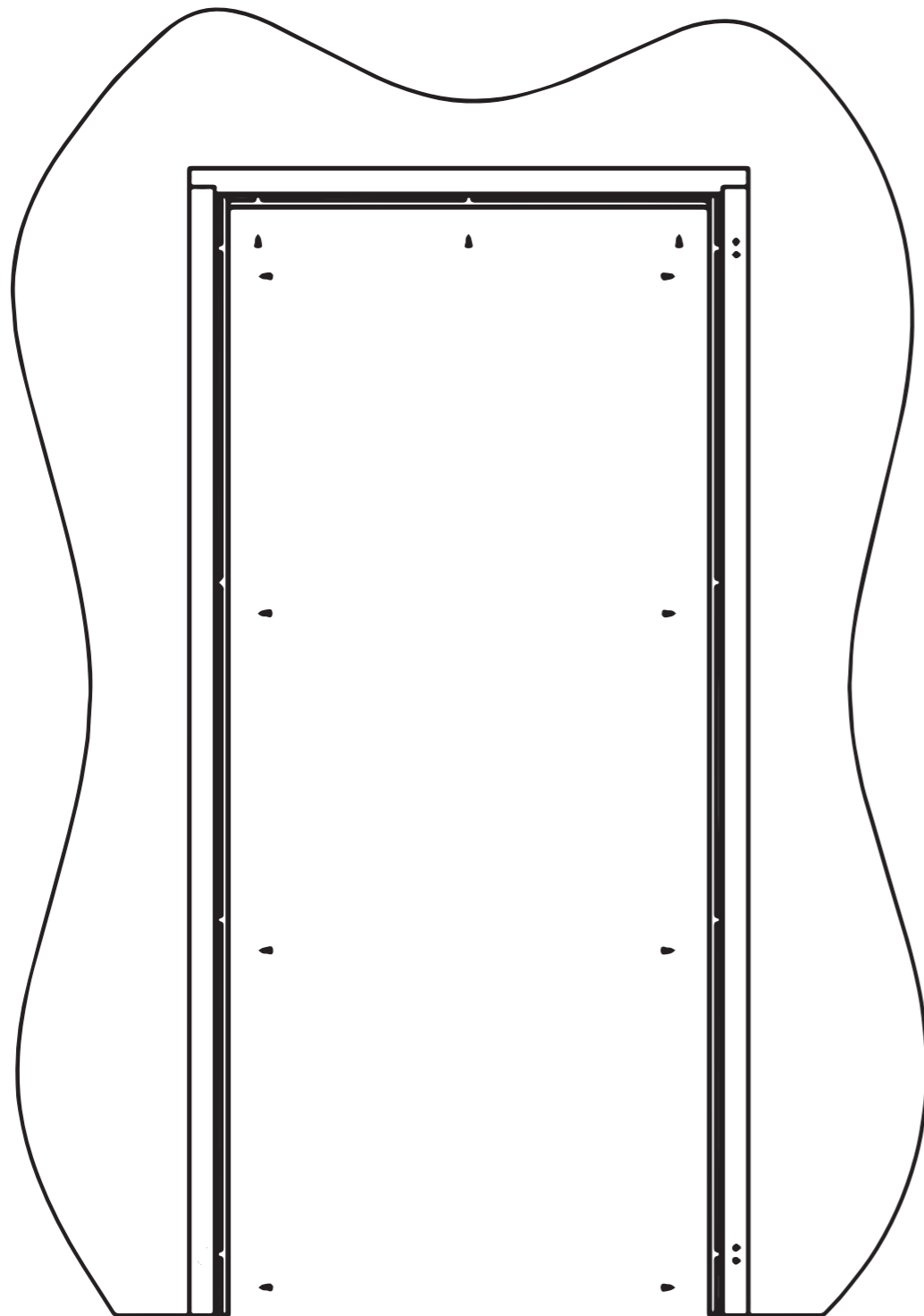

Fix both parts by using the supplied 11 screws.

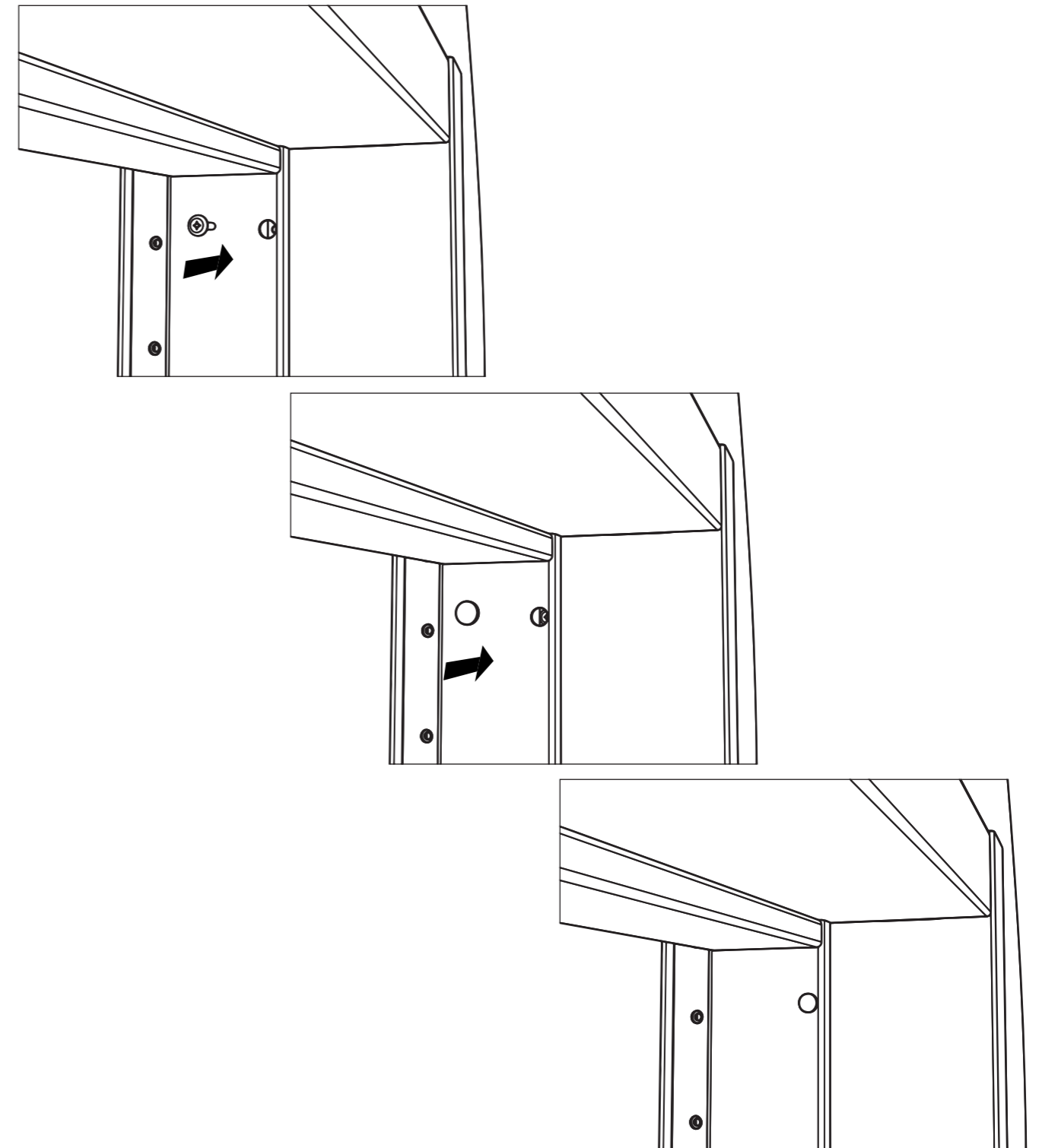

Seal the holes with taps as shown.